



[WWW.HSPUTELIDS.COM](http://WWW.HSPUTELIDS.COM)

Part No: J4R

Fitting Time: 120 minutes

**ROLL.Я.COVER**

Jeep Gladiator

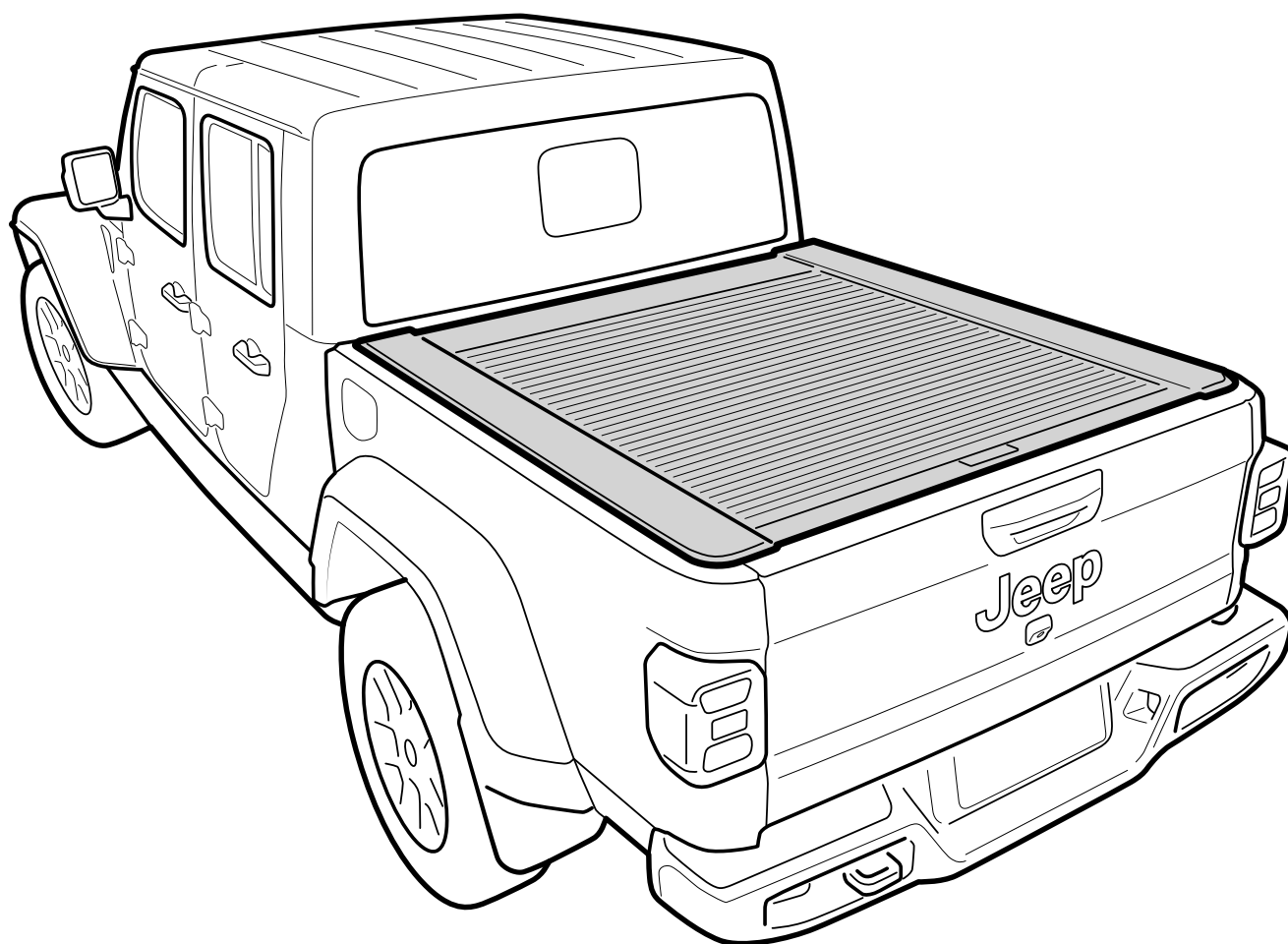

## Roll-R-Cover

---

### Fitting Instructions

## — General Notes —

- Read through the fitting instructions before installation of accessory.
- Always install the Roll R Cover Wiring Kit following the workshop manual and fitting instructions provided. Failure to do so may cause damage to the vehicle or the accessory.
- Ensure all recyclable components and packaging are discarded and recycled following local recycling regulations.
- It is always recommended that the Roll R Cover Wiring Kit is fitted by a qualified automotive technician.
- Safely store and protect any removed vehicle components.

## — Safety Notes —

- Check that all work practices comply with safety standards.
- Please wear appropriate clothing and use safety equipment.



## — Fitting Time —



120 minutes

## — Parts Supplied —

J4R	DUAL CAB JEEP GLADIATOR - ROLL R COVER		
<u>PART DISCRIPTION</u>	<u>PART NUMBER</u>	<u>QUANTITY/LENGTH</u>	<u>CHECK</u>
J4R FITTING INSTRUCTIONS	616	1	
J4R CANISTER AND CURTAIN	619	1	
COMPLETE CANISTER COVER	623	1	
J4R RAIL RIGHTHAND	617	1	
J4R RAIL LEFTHAND	618	1	
REMOTE	215	2	
CABLE TIE	501	1	
CABLE TIE 4.8X300MM	217	10	
HOSE 600MM	11	4	
ROLL R LOOM	216	1	
LUBRICANT SPRAY	47	1	
OPERATION LEAFLET	66	1	
MAINTENANCE LEAFLET	67	1	
BLACK NITRILE FOAM 6MMX12.5MMX1.8M	24	1.8M	
PRIMER STICK	44	1	
BLACK PUTTY	3	8	

## – Step 1

Remove and discard the front tie down rail.

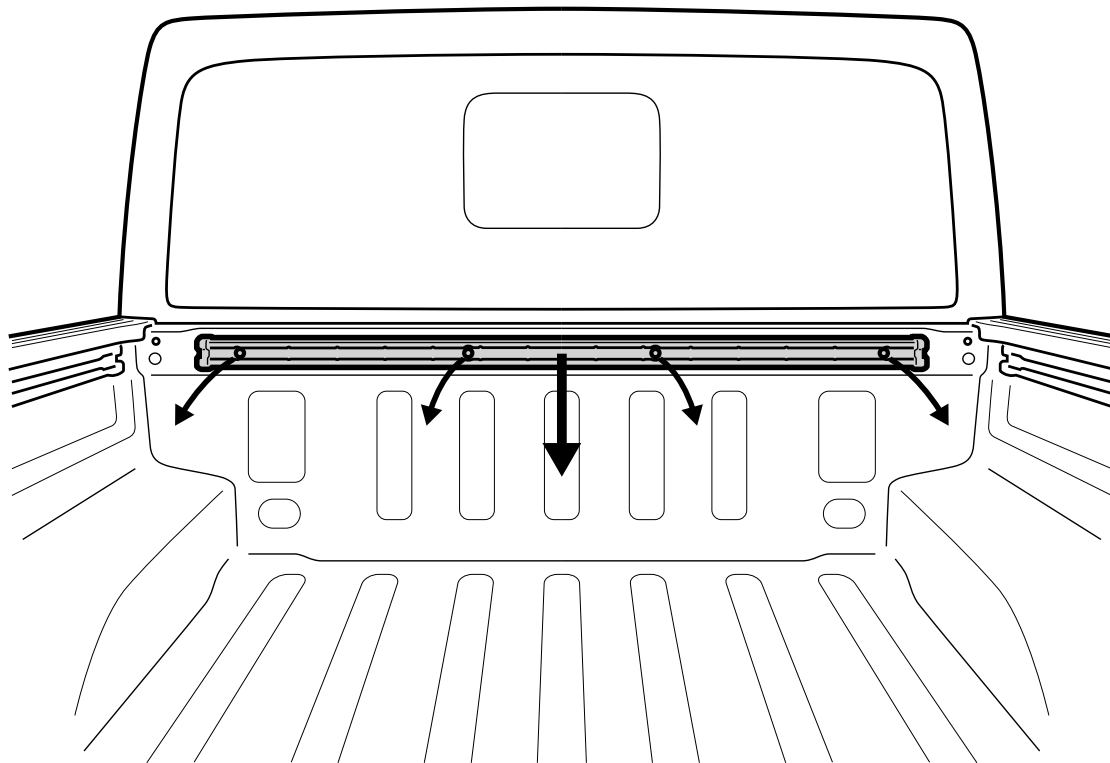

Drill the indicated hole to 19mm

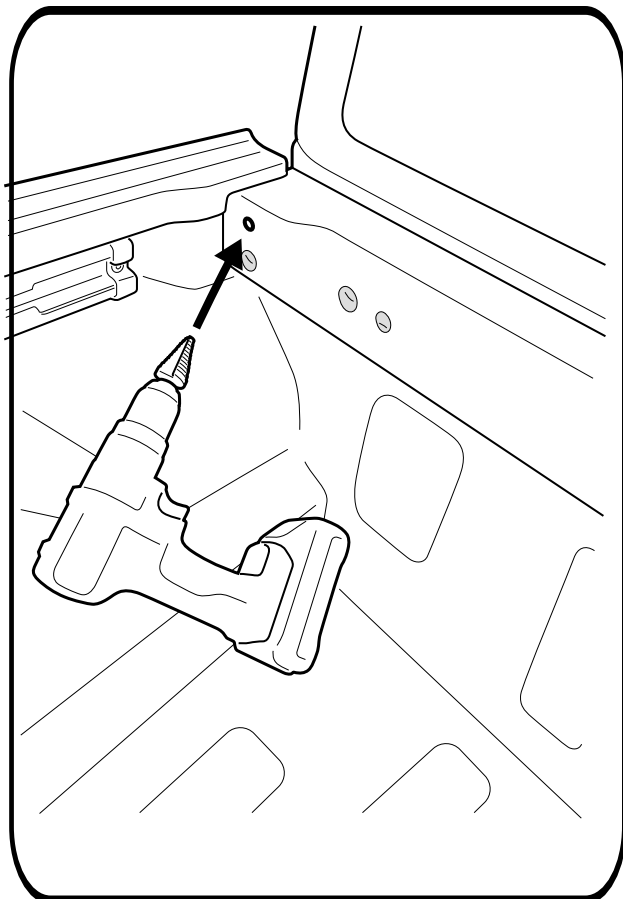

Apply rust inhibitor

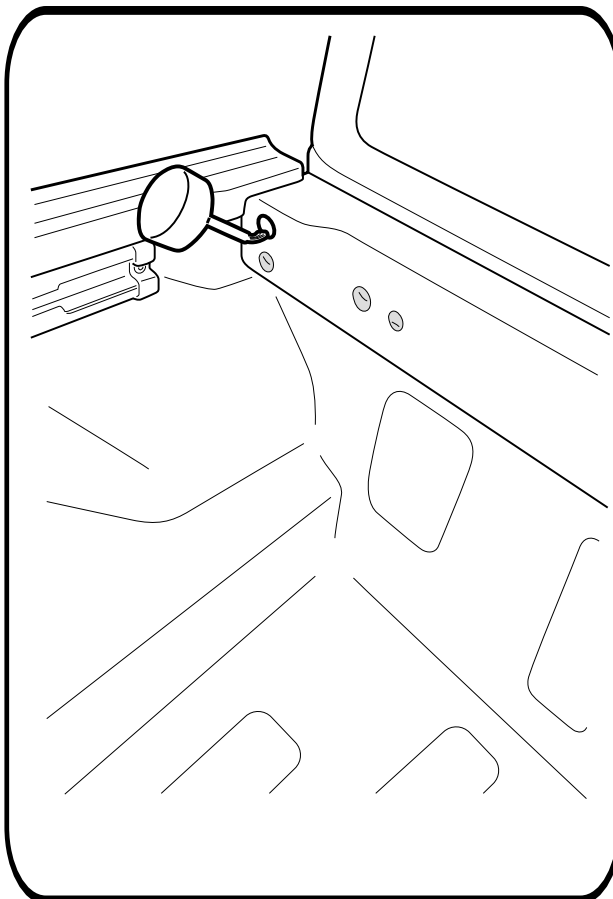

## – Step 2 –

### Roll-R-Cover preparation steps

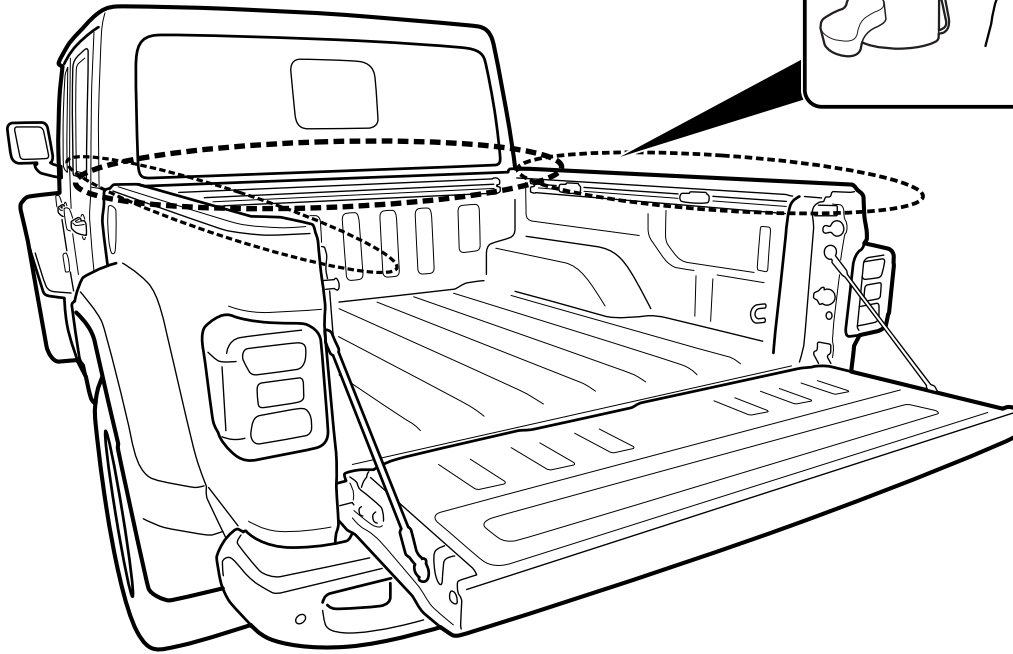

Slide out all side inner rail tie downs and retain.

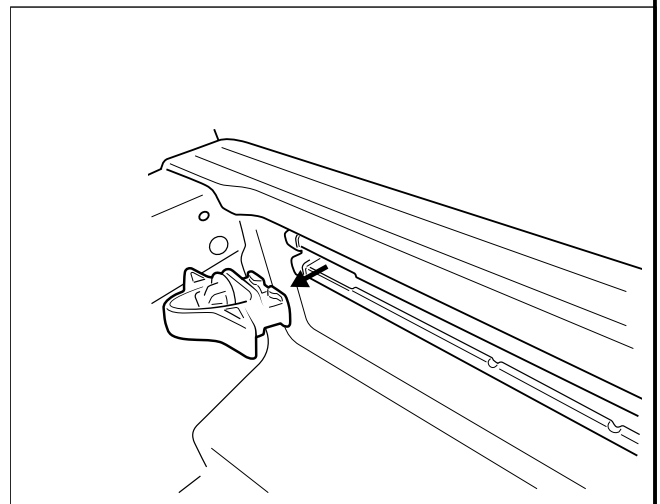
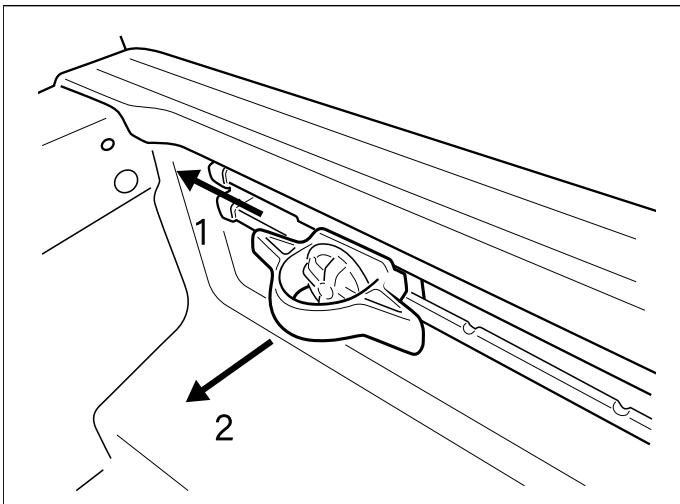

### — Step 3 —

Carefully unpack the box.

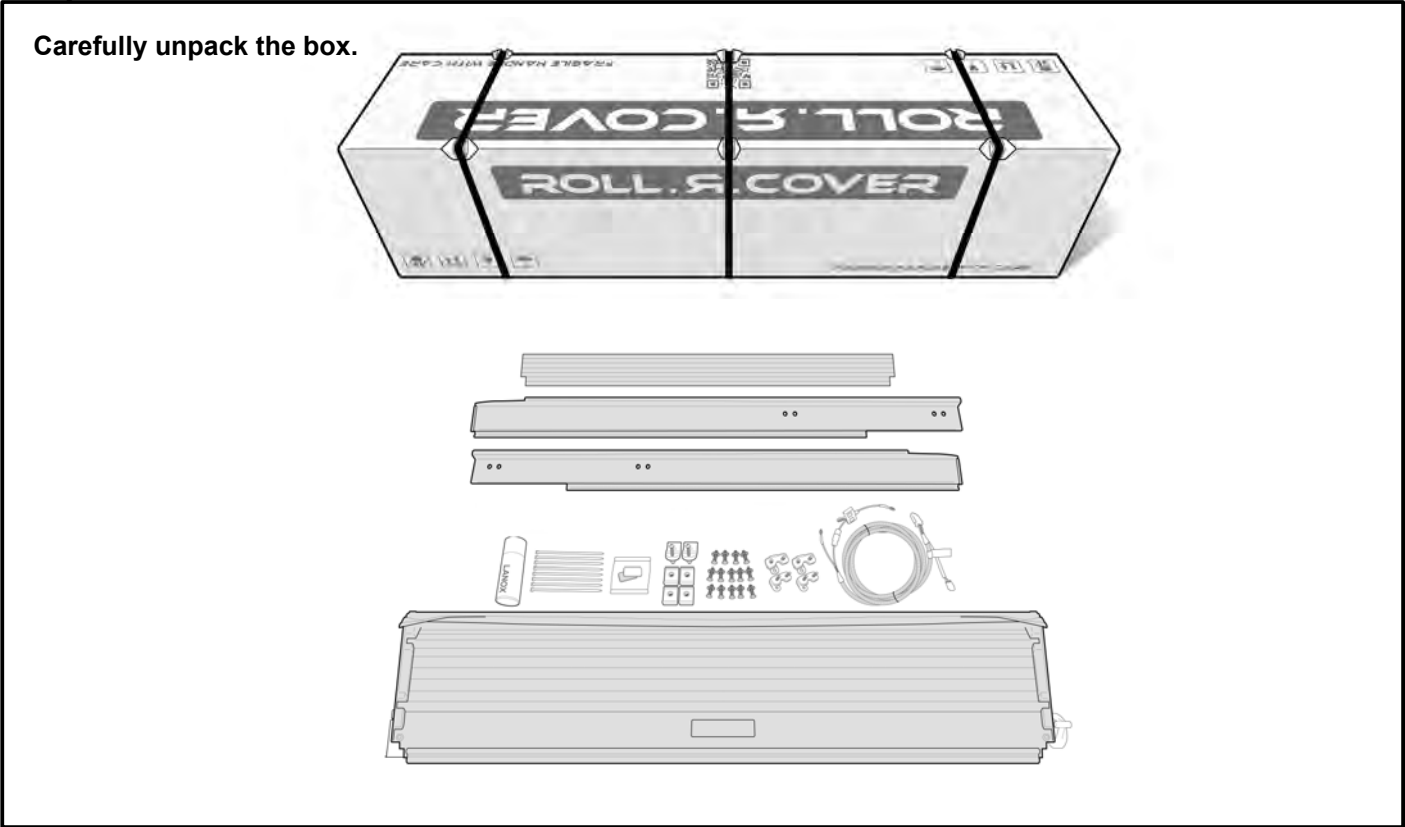
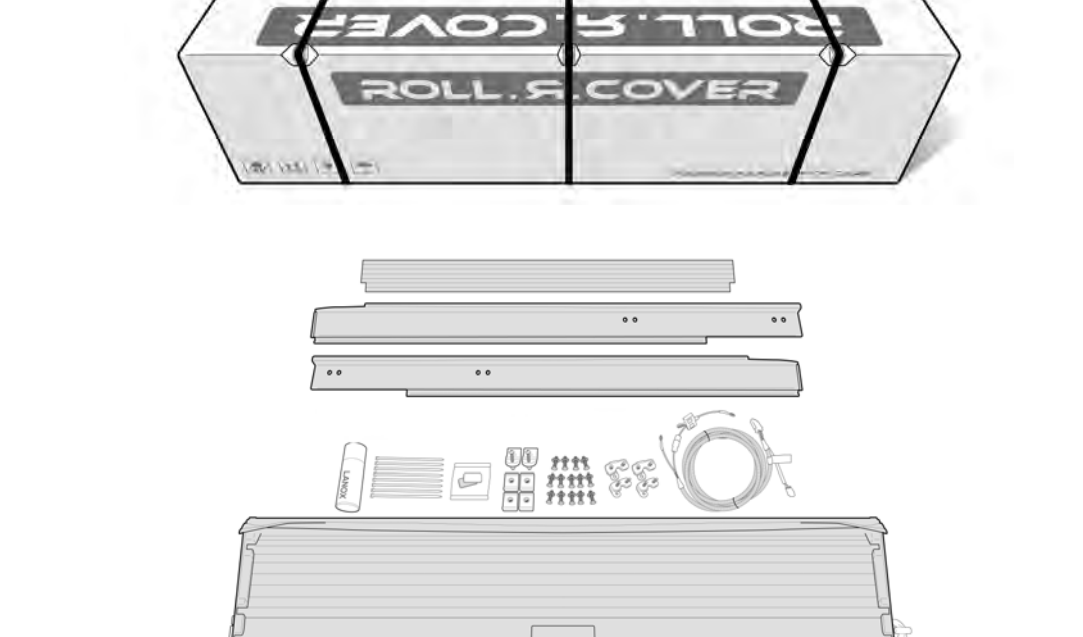

## – Step 4

**Wiring Harness steps**

**1** Feed loom through previously drilled hole.

**2**

**3**

**216**

Run the wiring from the front corner cavity to the battery over the chassis rail. Making sure to keep away from hot obstructions and cable tie every 400mm.

**Wiring Harness steps**

**1** Feed loom through previously drilled hole.

**2**

**3**

**216**

Run the wiring from the front corner cavity to the battery over the chassis rail. Making sure to keep away from hot obstructions and cable tie every 400mm.

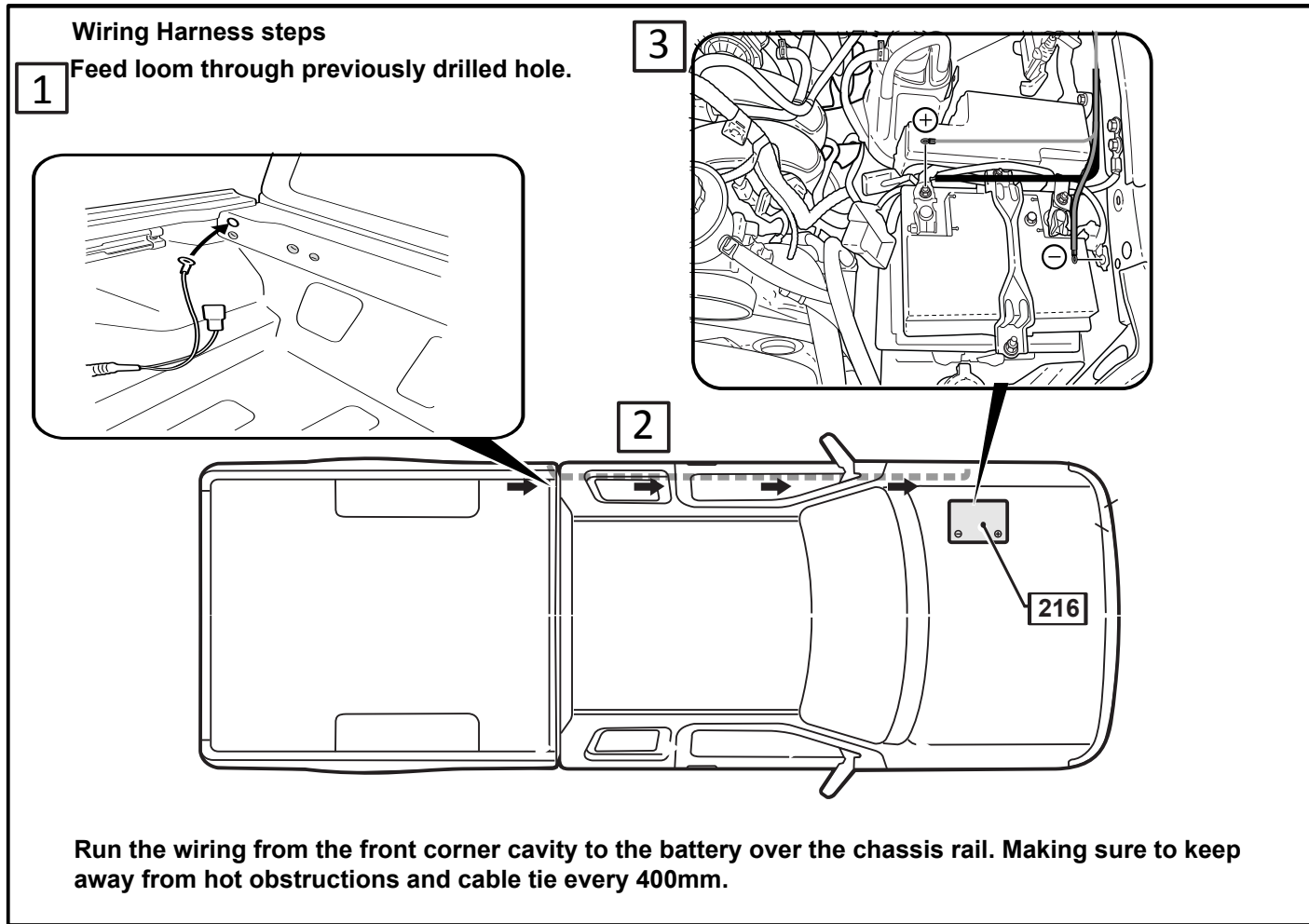

**Wiring Harness steps**

**1** Feed loom through previously drilled hole.

**2**

**3**

Run the wiring from the front corner cavity to the battery over the chassis rail. Making sure to keep away from hot obstructions and cable tie every 400mm.

## – Step 5

Remove M8 Bolt & M8 Spring Washer

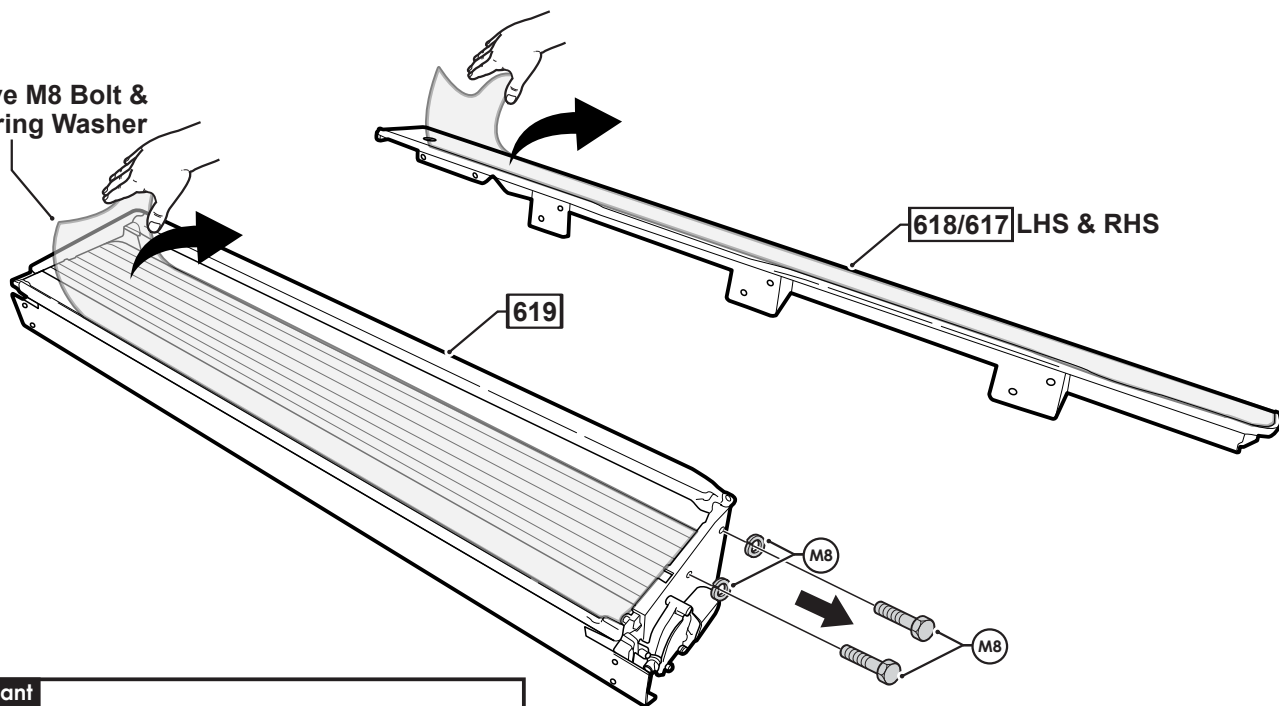

**Important**



Ensure the black tar is not removed with the film.

## – Step 6

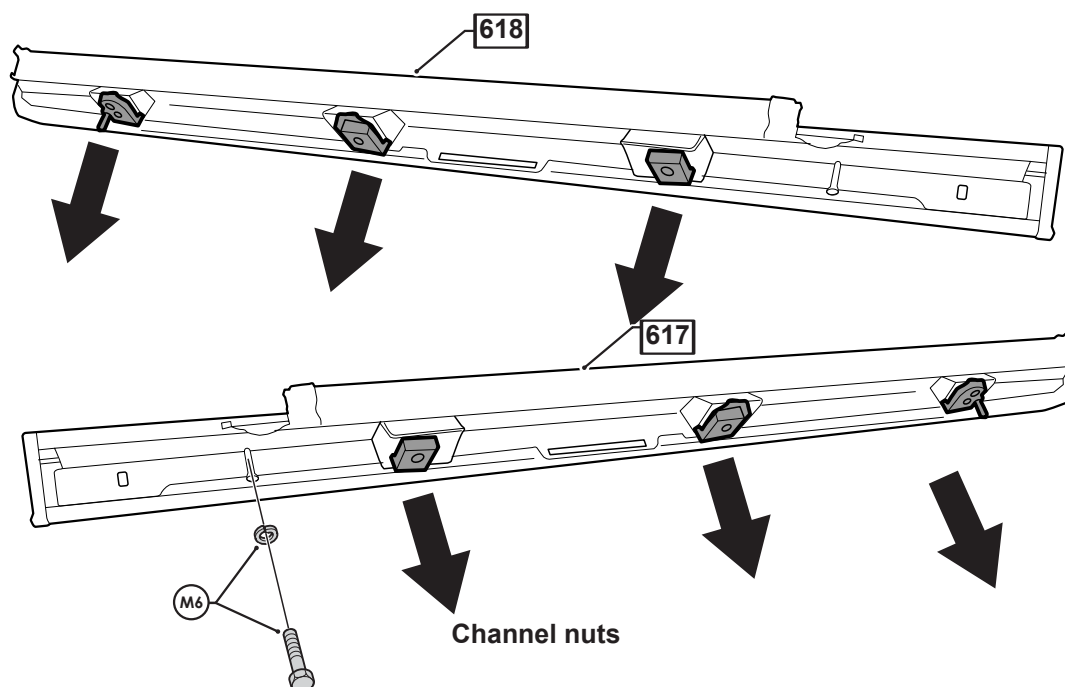

Channel nuts

M6 Bolt and M6 Spring Washer is only on the RHS Side Rail

## – Step 7

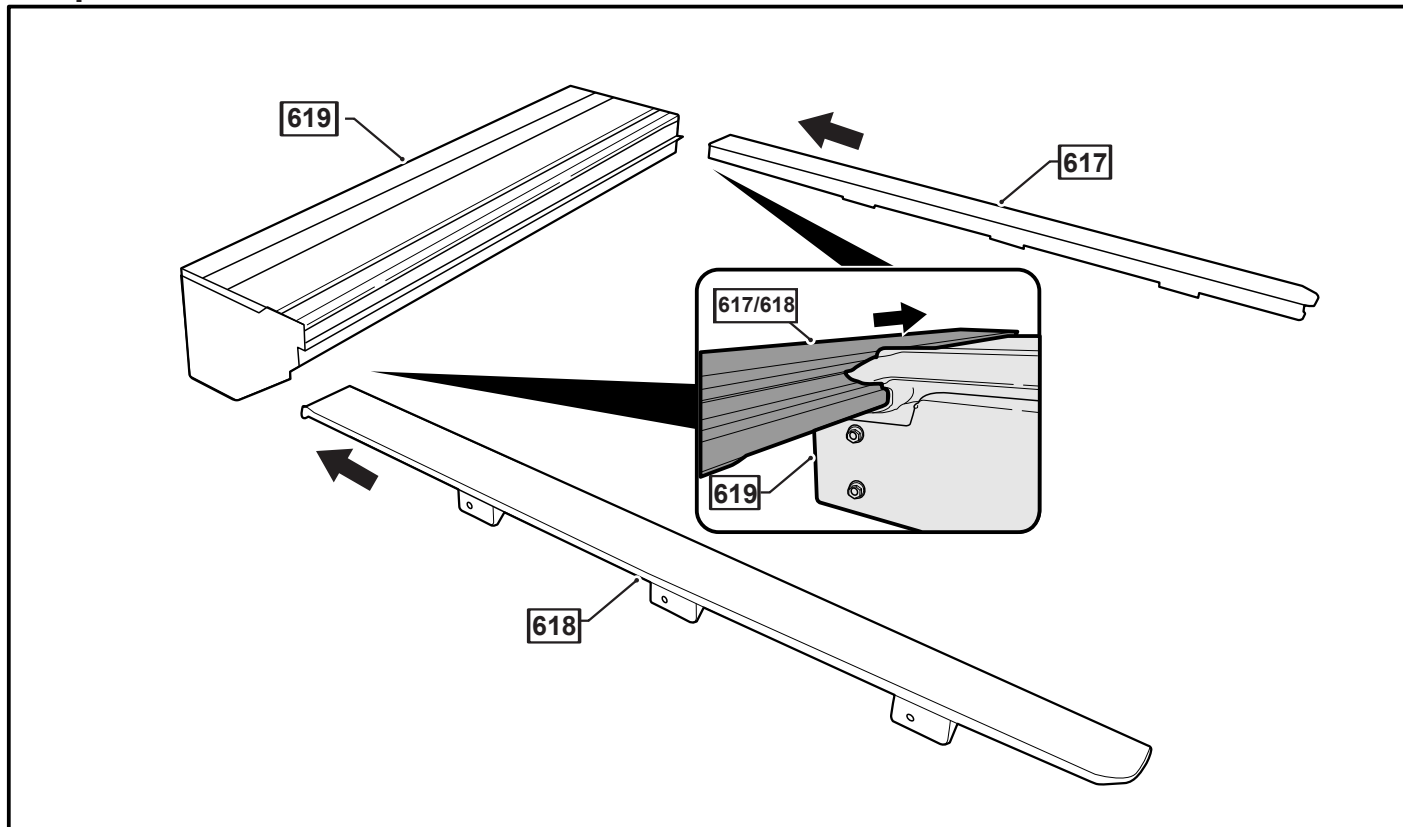

## – Step 8

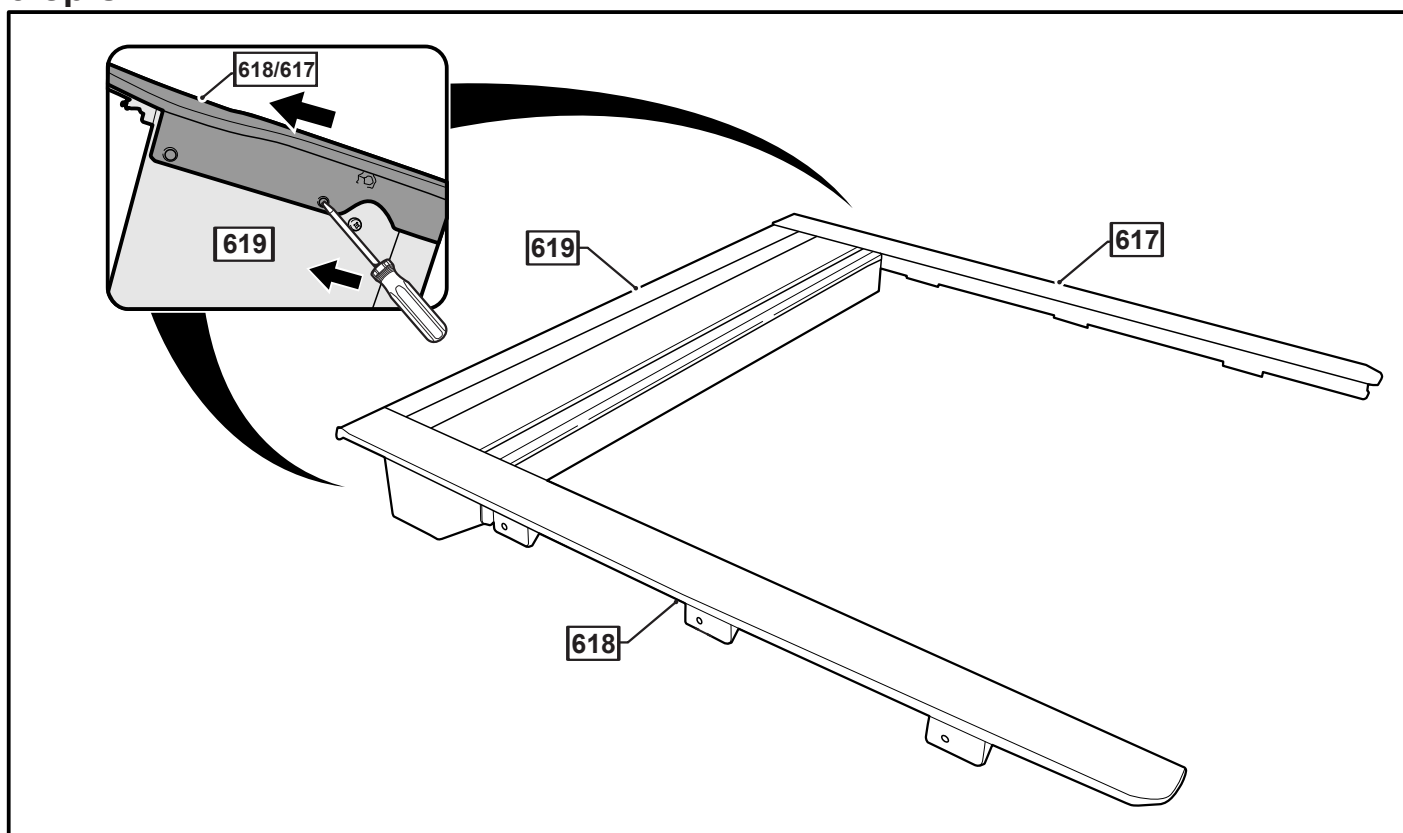

## – Step 9

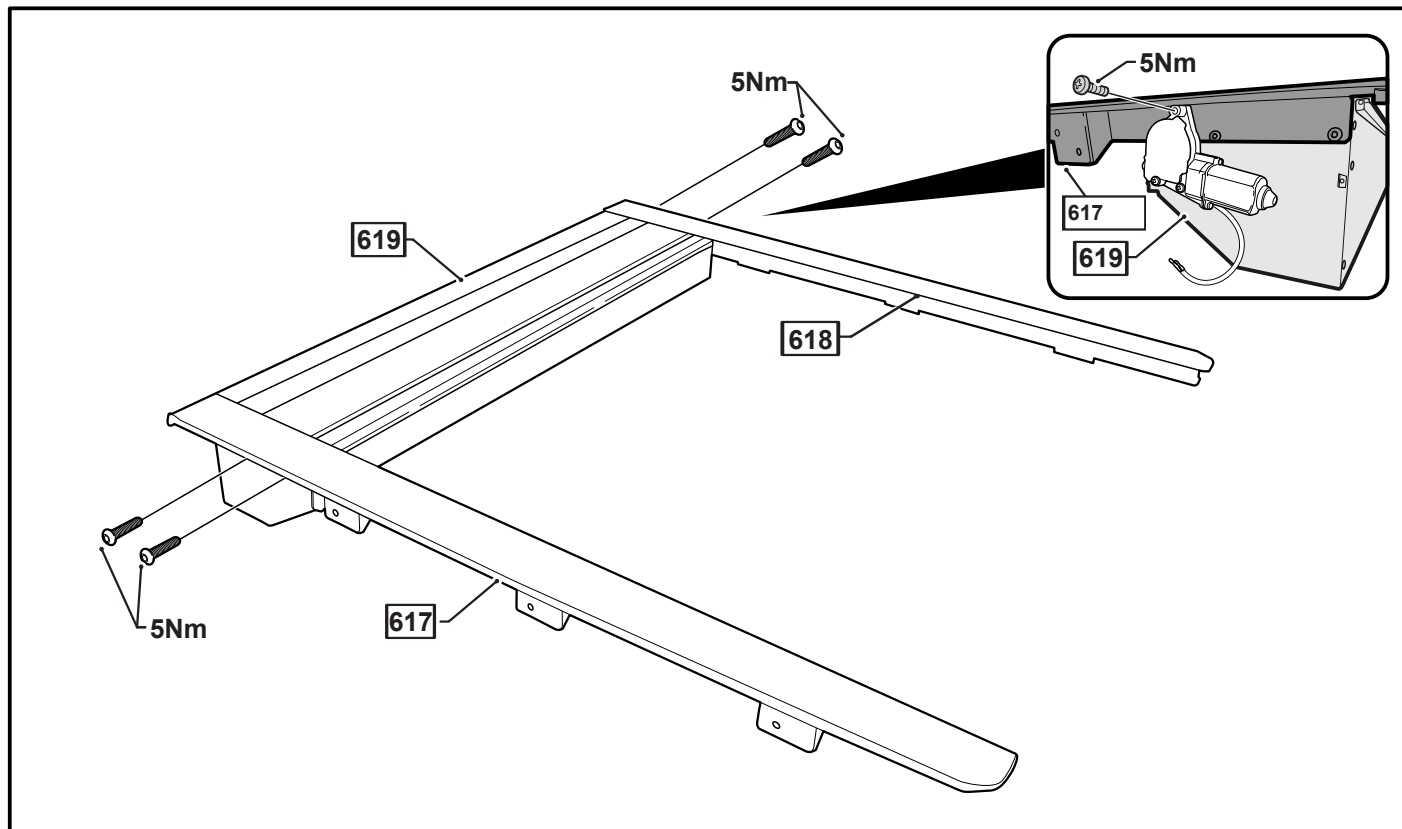

## – Step 10

Apply tar sealant to the gap under water channel.

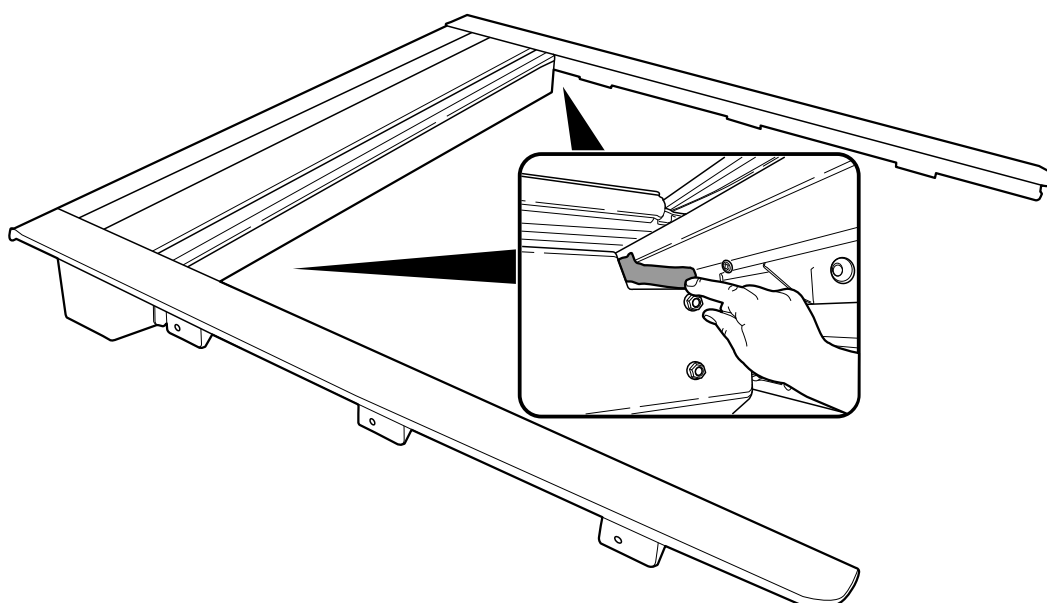



## – Step 11 –

Apply tar sealant to all the holes on head board

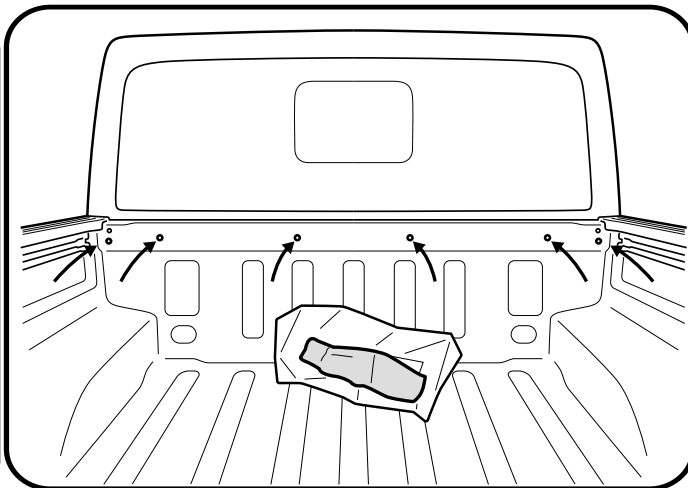
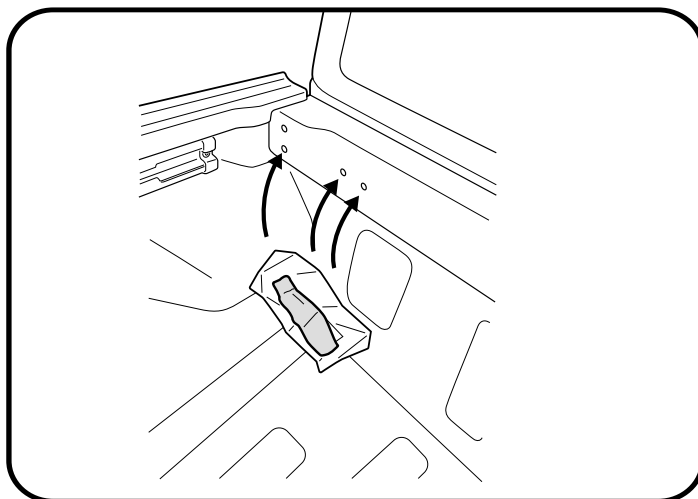

Apply tar sealant to any gaps on the head board.

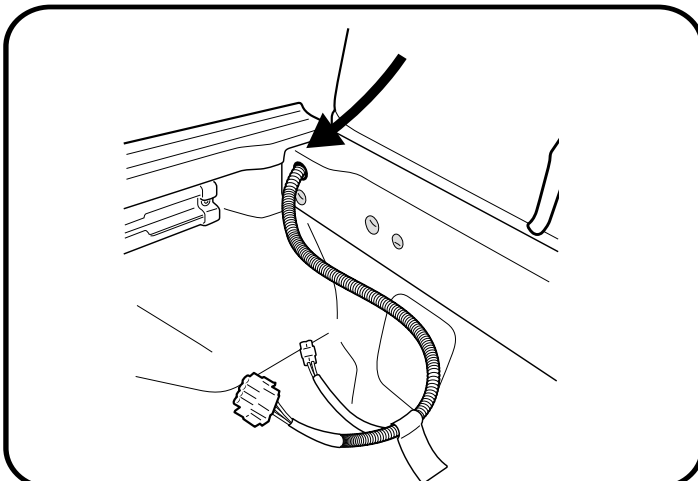

Apply 3m primer to head board.

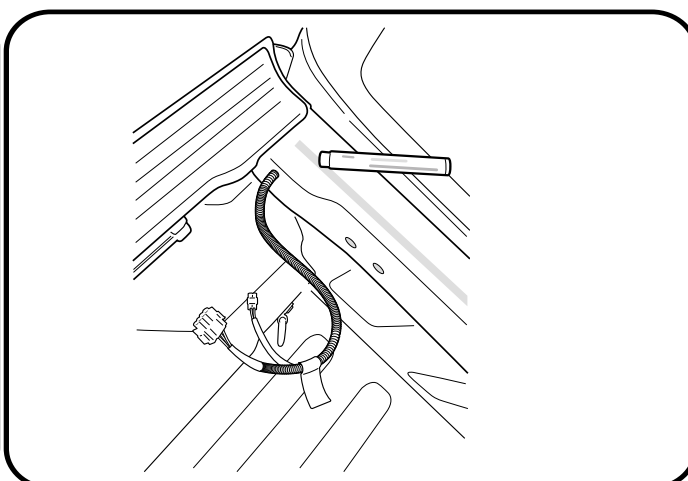

## – Step 12 –

Run foam seal provided along the front of the tub to make headrail level with sides.

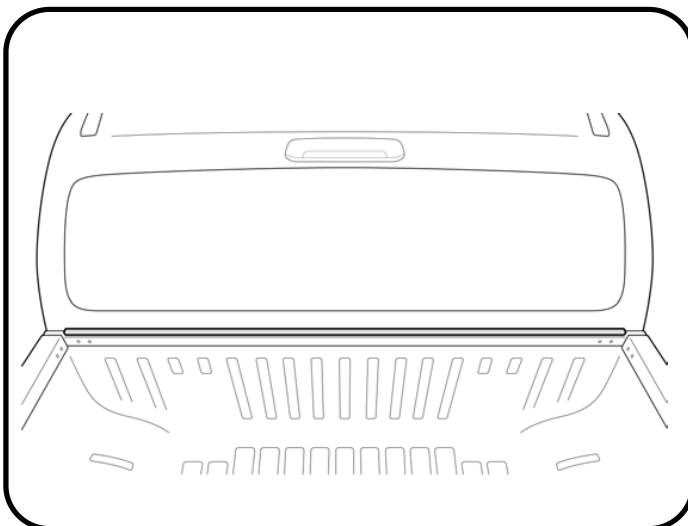
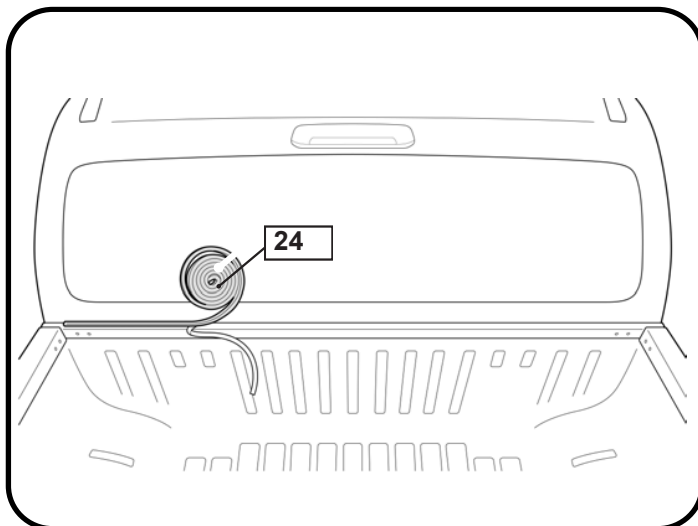

## — Step 13 —

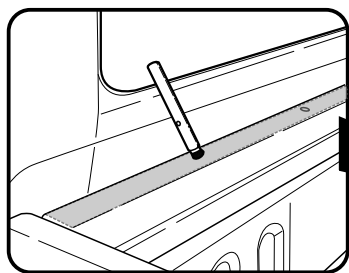

**Apply 3m primer, to the top of the black nitrile foam.**

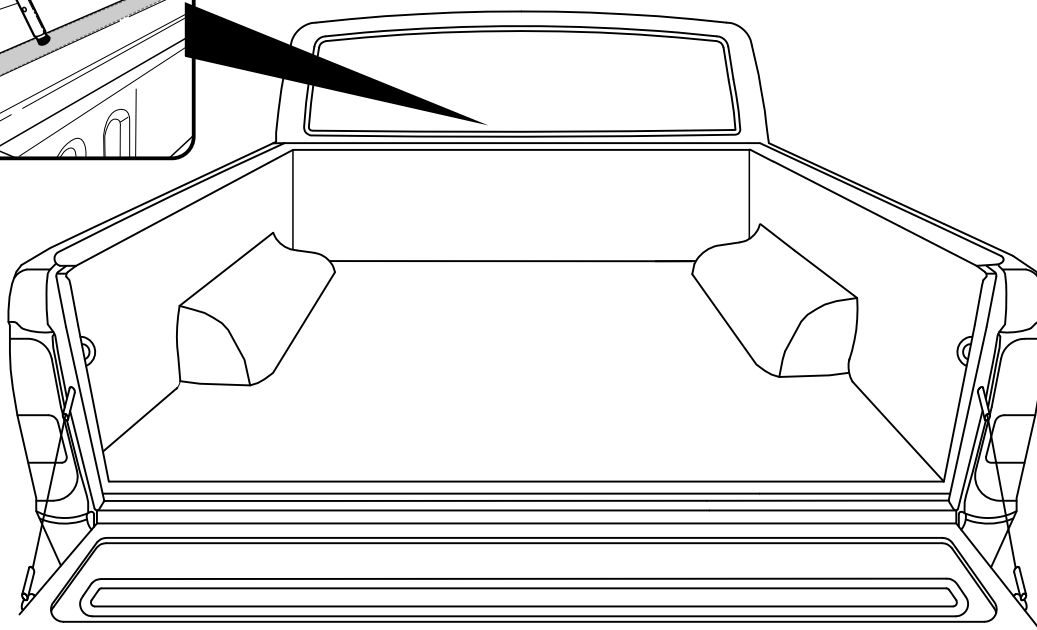

## —Step 14—

Slide one channel nut into tiedown rail, followed by tie down.

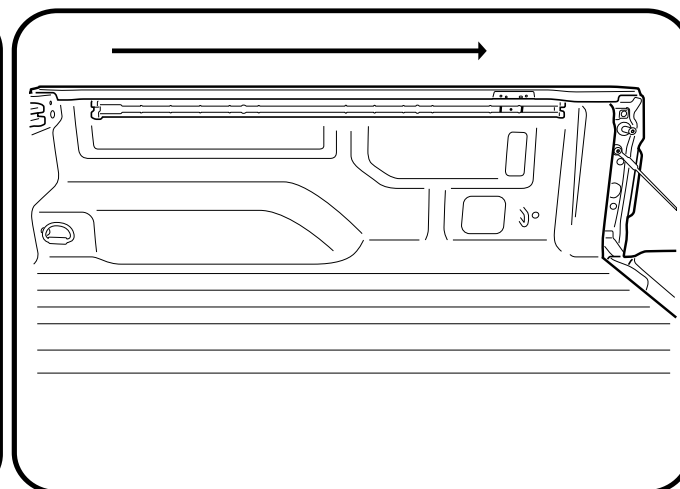
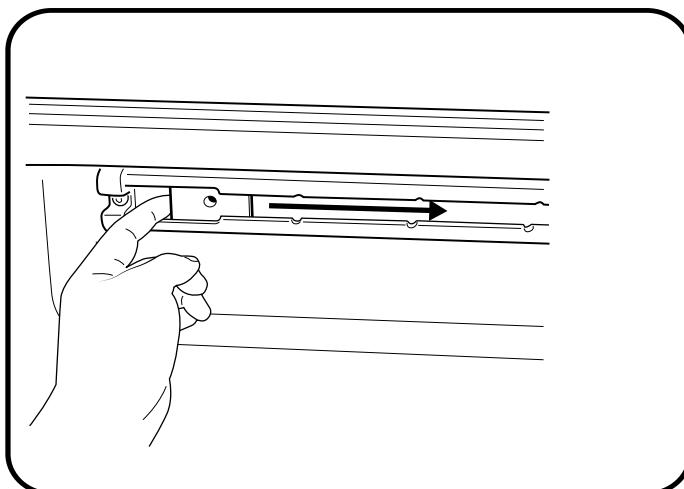
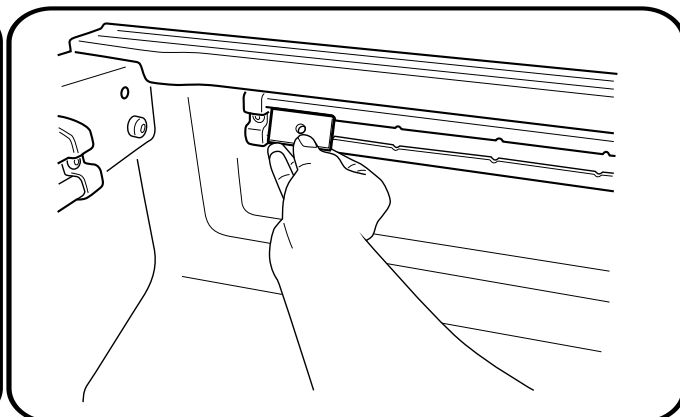
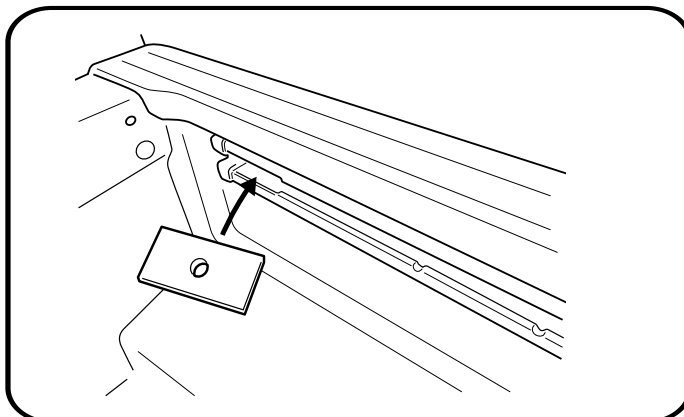

1. Channel nut
2. Tie down
3. Channel nut
4. Tie down
5. Channel nut

Repeat to the other side.

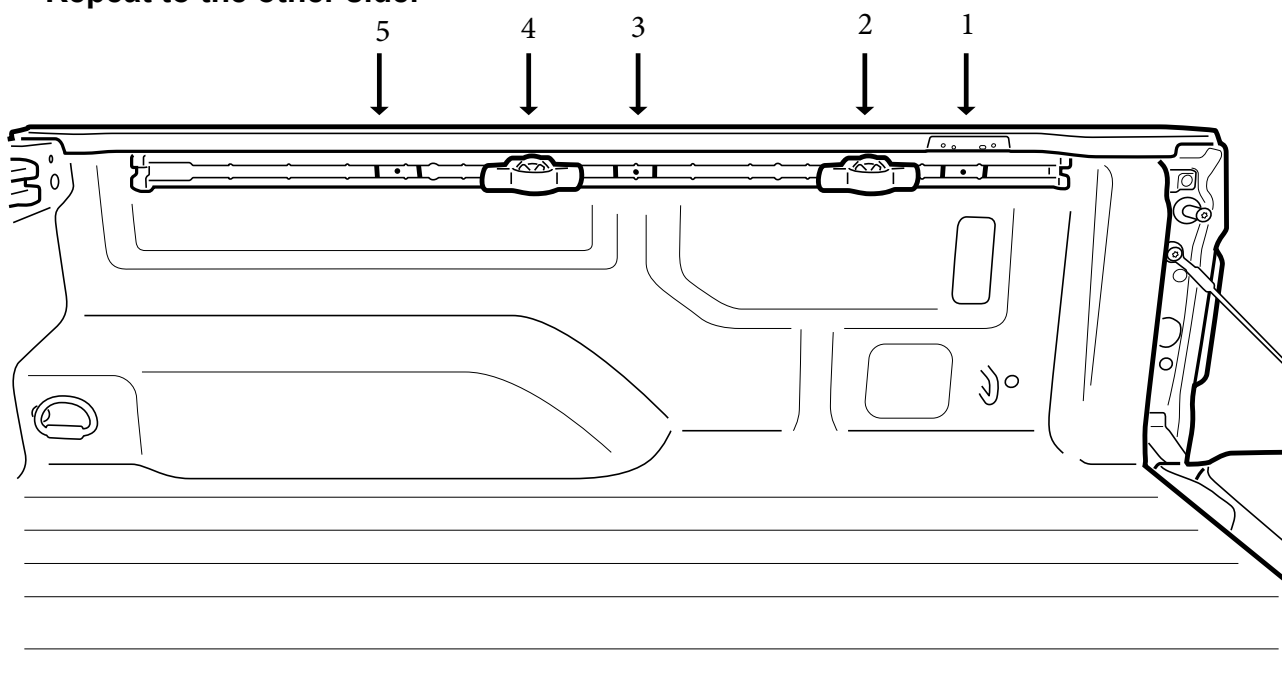

## — Step 15 —

### Installing the Roll-R-Cover

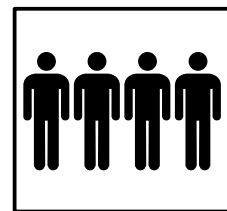
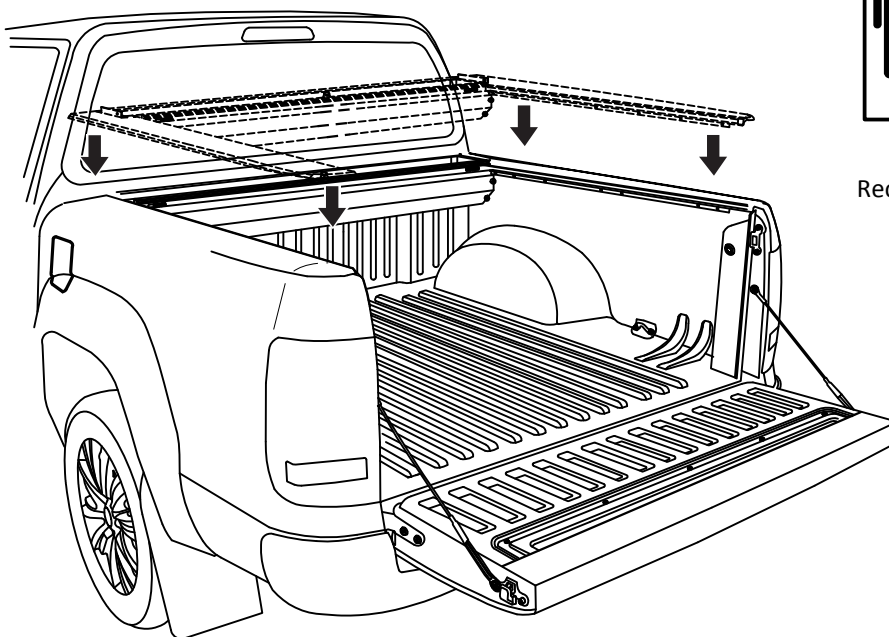

4 People  
Recommended for lift

## — Step 16 —

Before dropping the Roll R cover into place on the tub, connect all relevant connections or plugs to the receiver and motor plug connection.

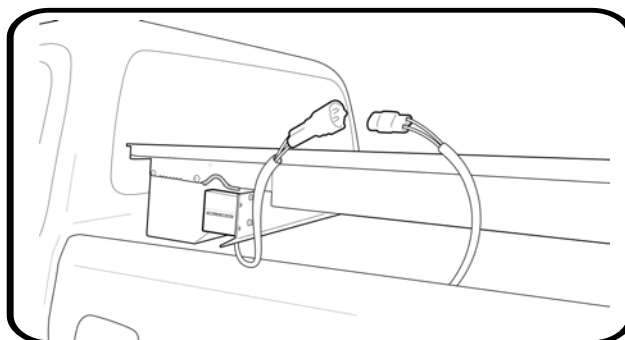
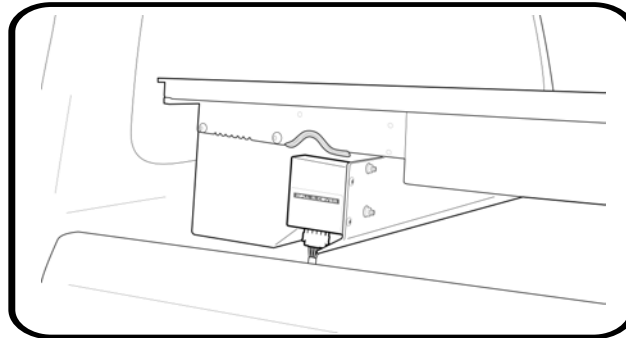
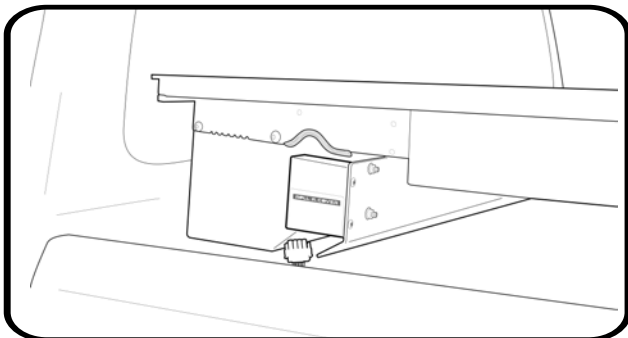

## – Step 17 –

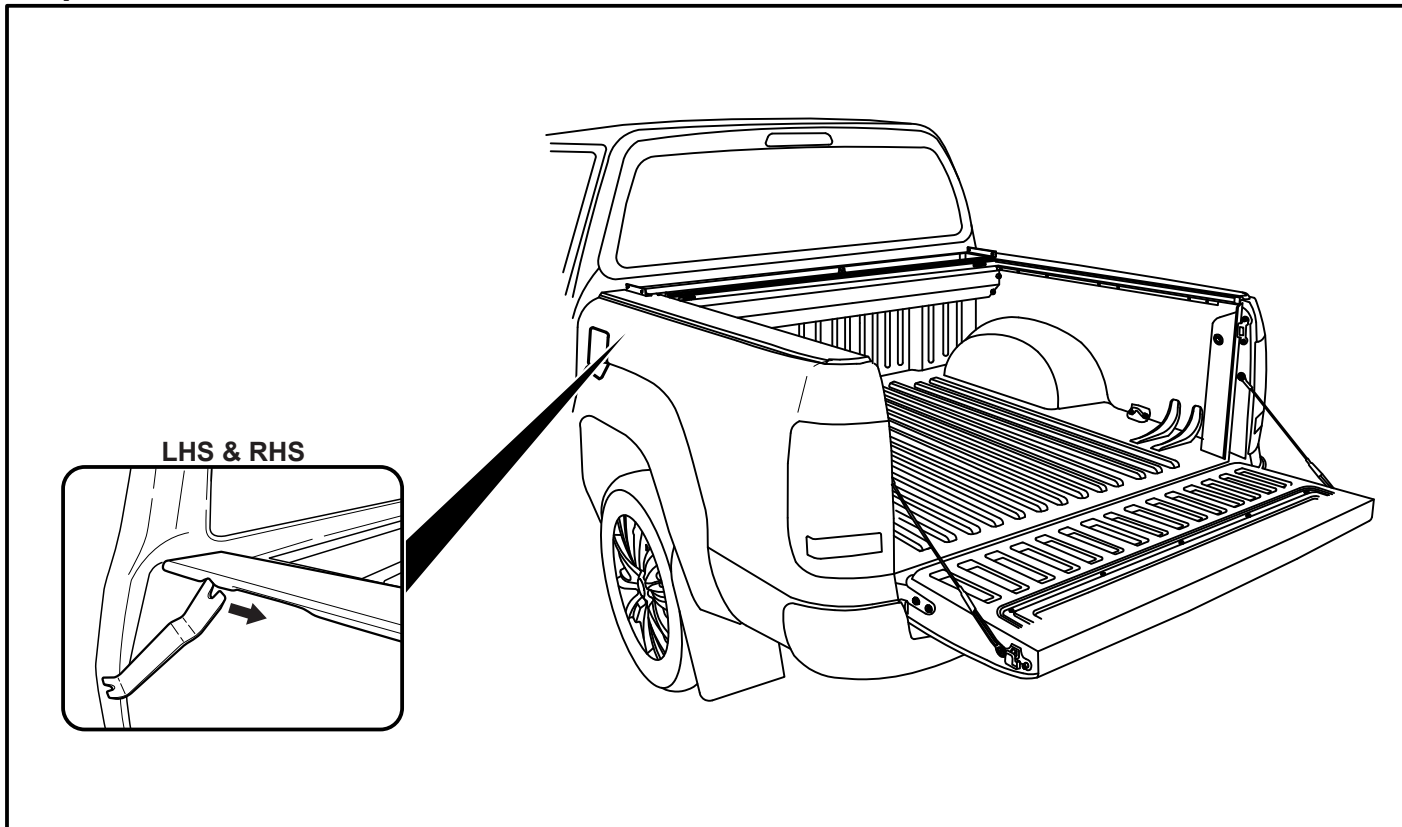

## – Step 18 –

Position the channel nuts with the side rail clamping tabs.. LHS & RHS  
Loosely fasten in to position by feeding the flat washer, spring washer and the m8 bolt.

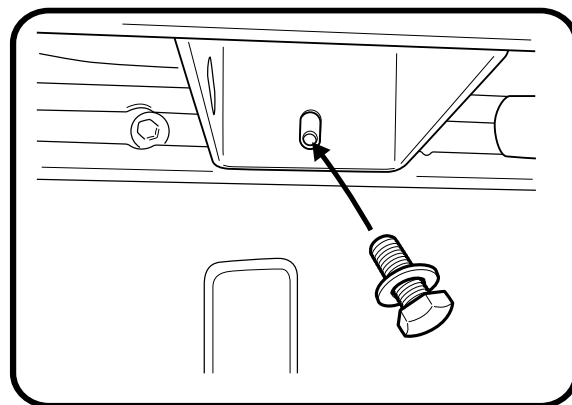
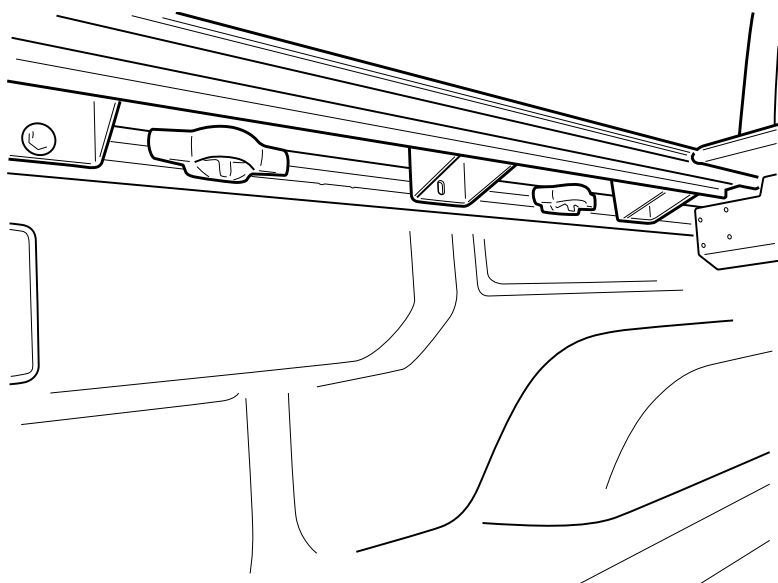

## – Step 19 –

### Important



With assistance, keep the 2 side rails slightly up and close the tailgate.  
Side rail rubber must have a 2mm gap from the top of the tailgate in the closed position.

Adjust the side rails so the tailgate compresses the foam seal by 1mm.

Foam to compress by 1mm

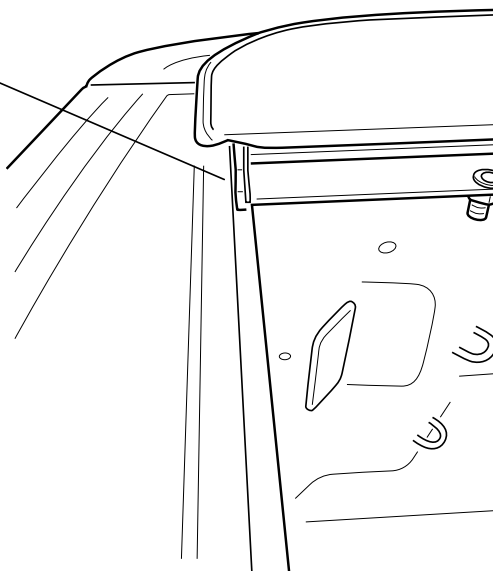

## – Step 20 –

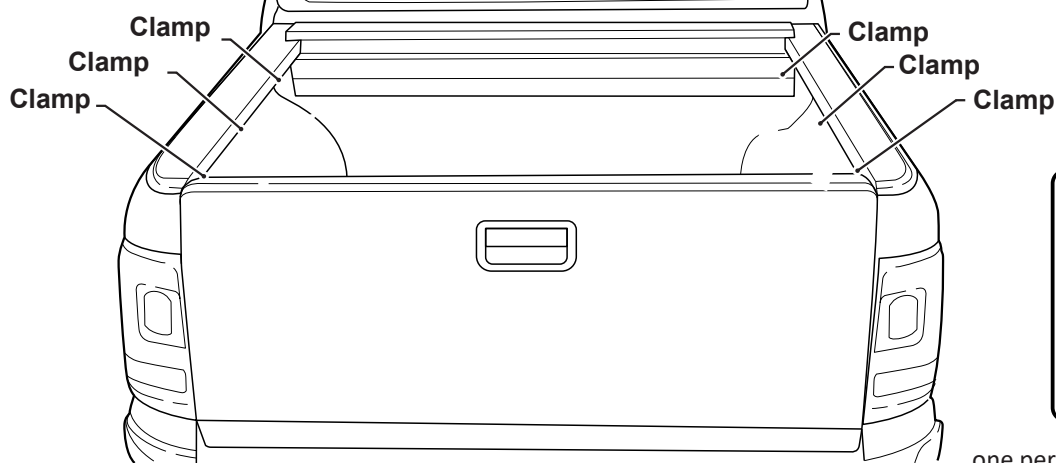

one person to apply pressure, the other to tighten clamps

## – Step 21

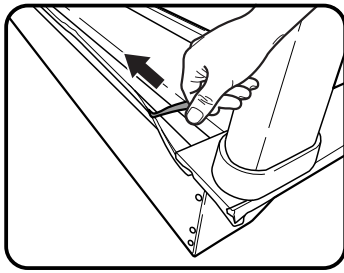

Peel double sided tape backing off and stick to black nitrile foam.

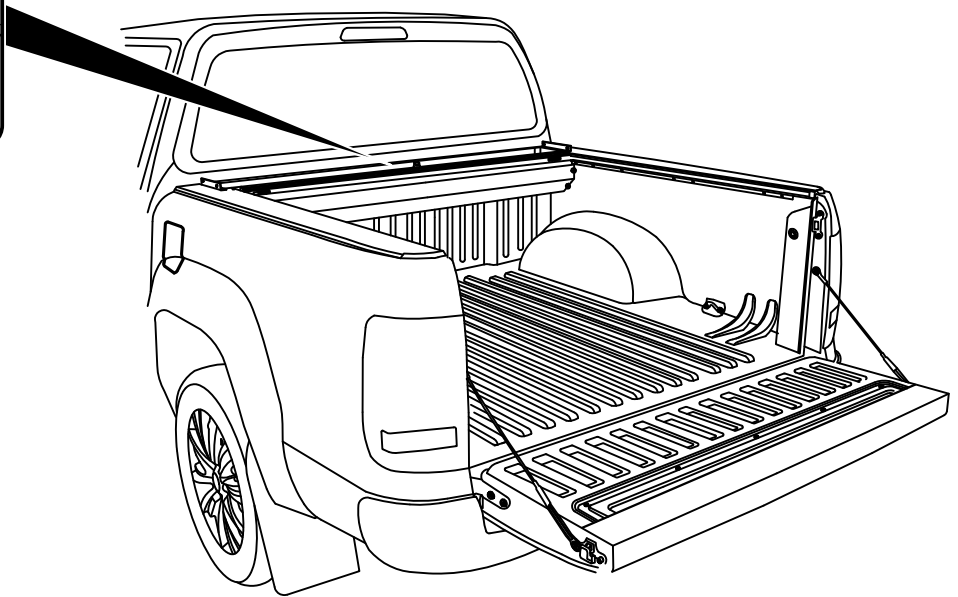

## – Step 22

Locate the factory holes at the front 2 corners next to the factory tie downs.

- connect the pipe to drainage of the canister.
- feed the pipe through the factory holes.

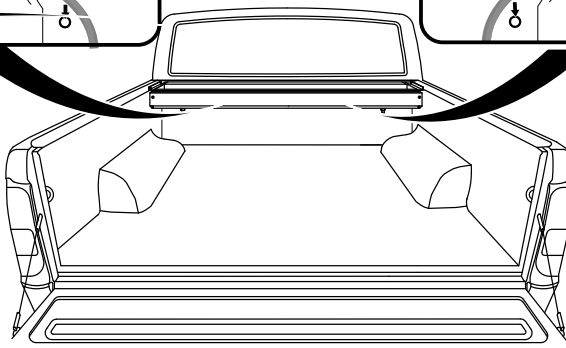
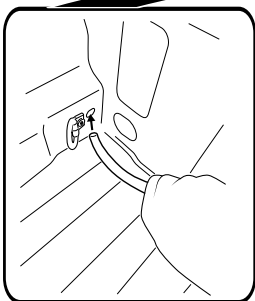
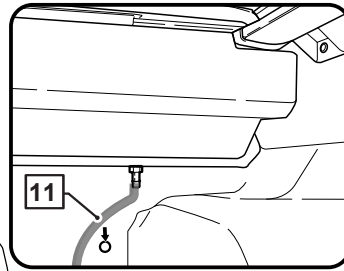
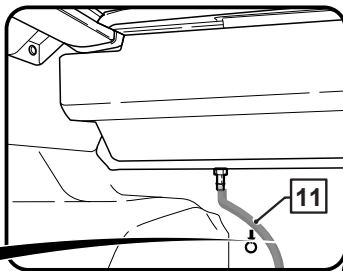

Important



The drain pipe should exit the tub hole by 10mm, cut the excess and discard.  
Make sure the drain pipe are NOT aligned with or through the cab vents.

## – Step 23 –

Use the factory holes to feed the rear drain pipes through.

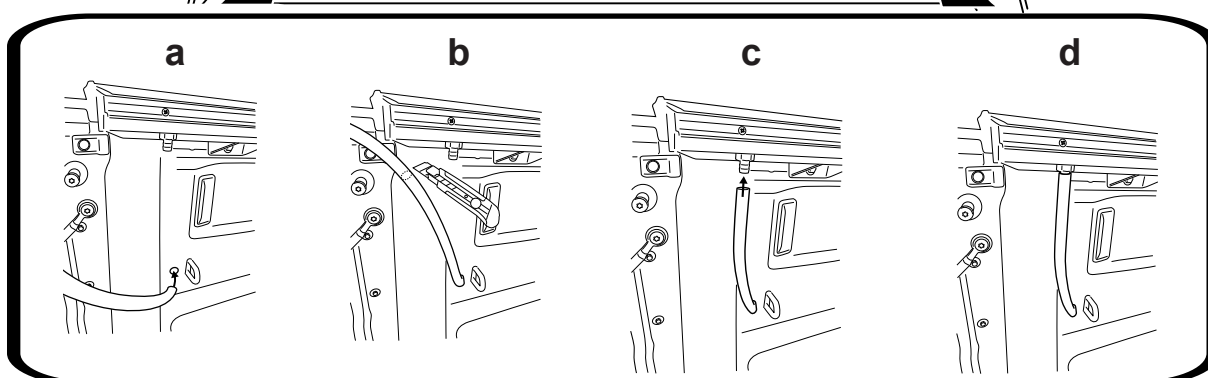
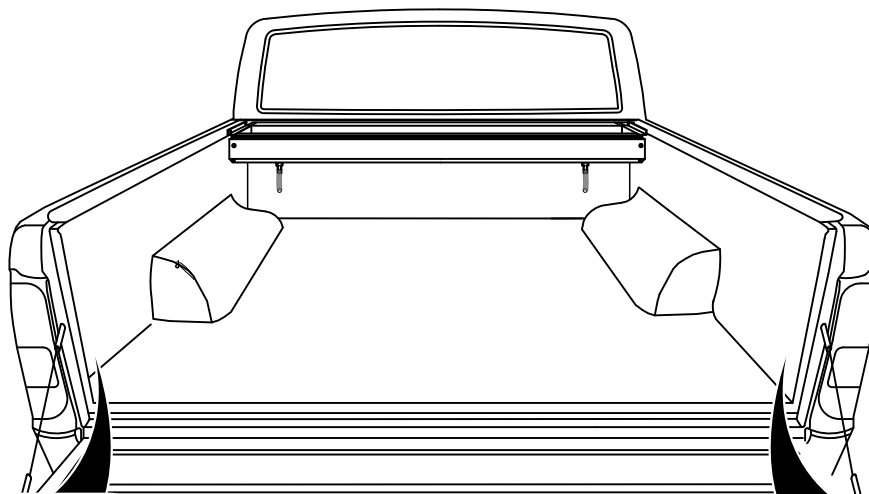

## – Step 24 –

Snap fit the top cover.

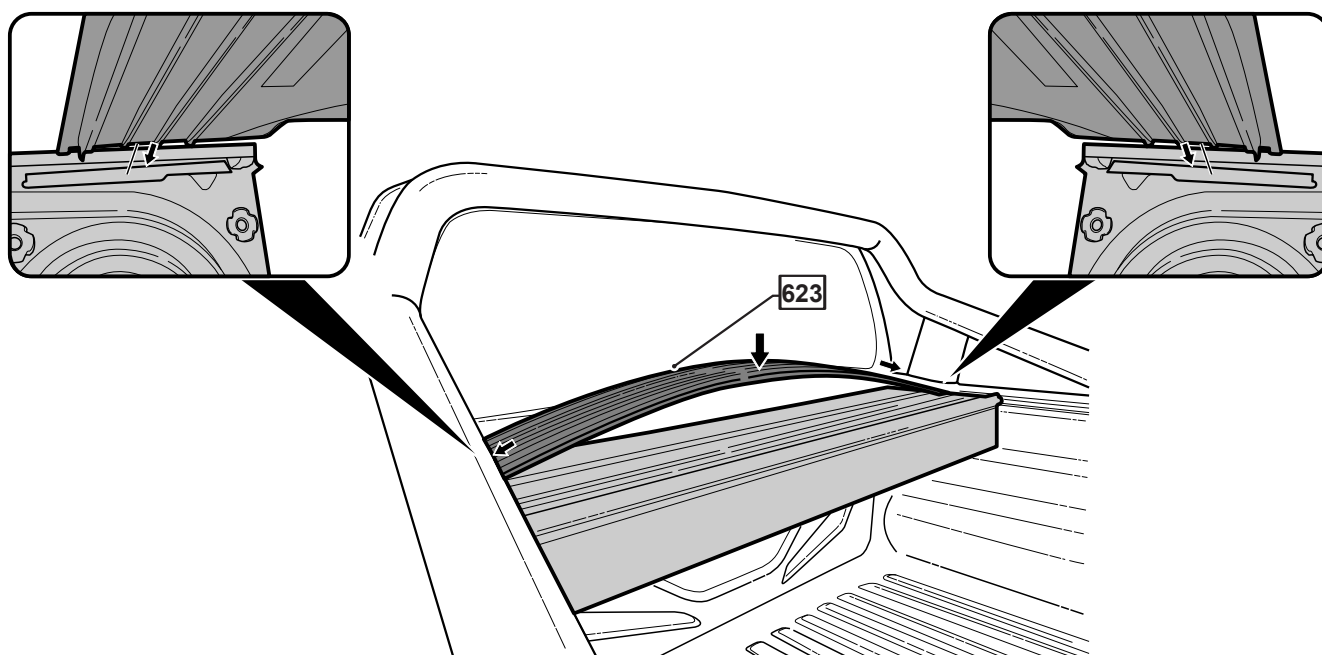



## – Step 25

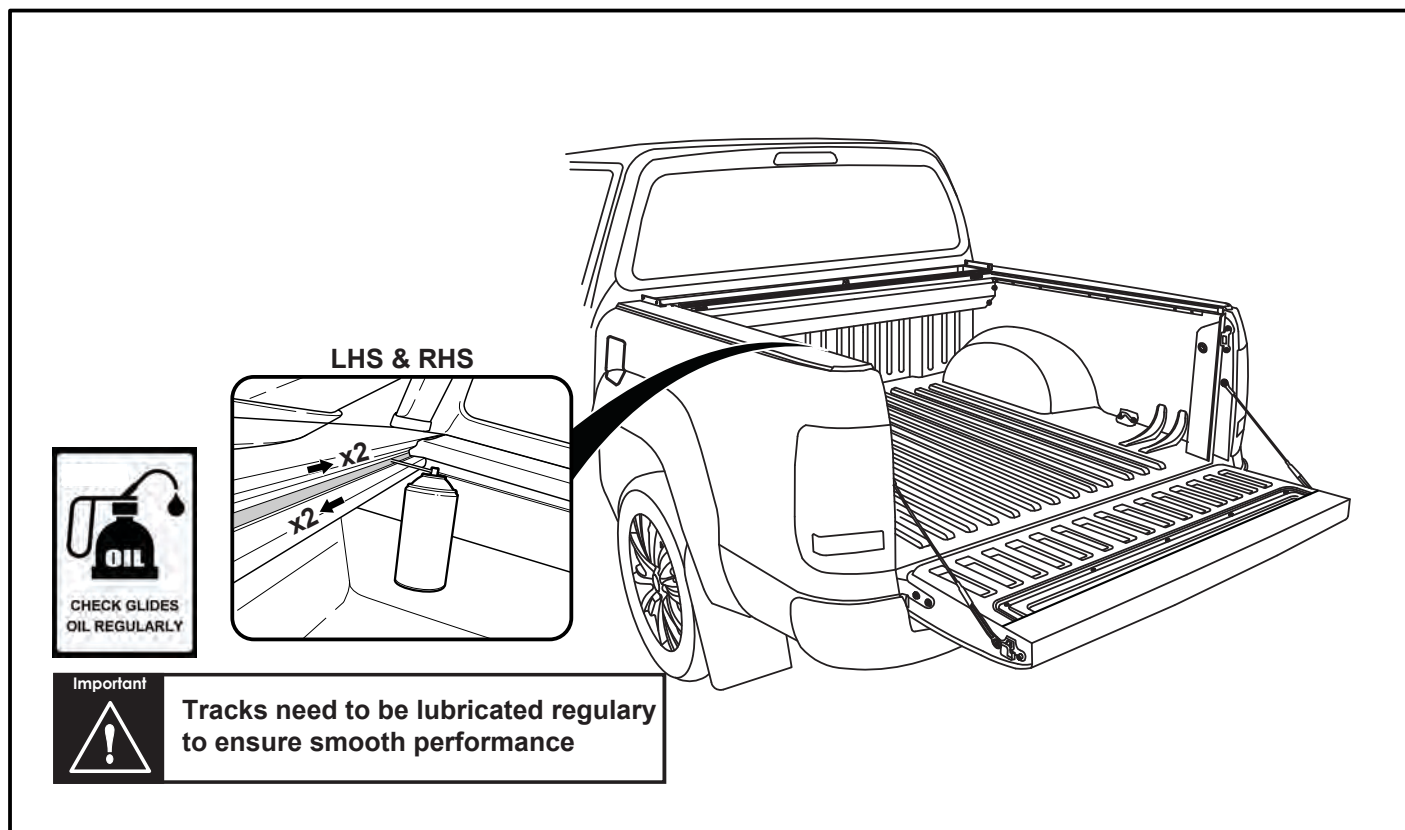

## – Step 26

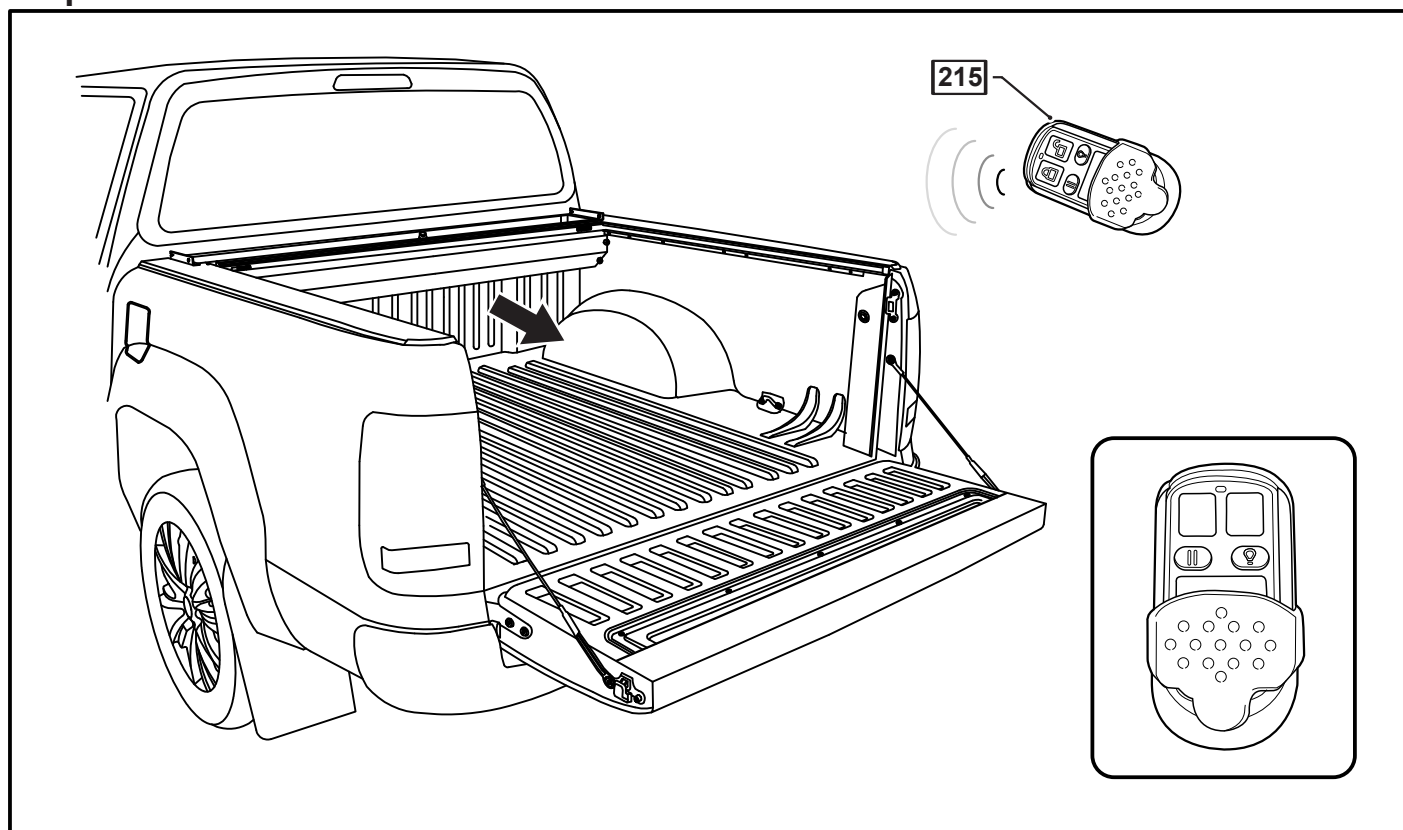

**WARNINGS!**

[www.hsputelids.com](http://www.hsputelids.com)

 NO STANDING	<b>ENSURE</b>  <b>LOAD IS SECURE</b>	 CHECK GLIDES OIL REGULARLY	 6Nm CHECK CLAMPS AND TIGHTEN	 kg DO NOT PLACE LOAD ON COVER	<b>CHECK DRAIN</b>  CLEAN CANISTER	  MECHANICAL HAZARD	<b>NO PEOPLE OR</b>  ANIMALS UNDER ROLL TOP
--	---	--	---	--	--	--	---

E. & O.E. This document is copyright and must not be used except as permitted below or under the Copyright Act 1968. You may reproduce and publish this document in whole or in part for your or your organisation's own personal or internal compliance, educational or non-commercial purposes. You must not alter or amend this document in any way. You must not reproduce or publish this document for commercial gain without the prior written consent of the copyright owner.