

AUSTRALIA'S BEST 4WD DRAWER SYSTEM



SUPER STRONG
& LIGHTWEIGHT



100% DRAWER
EXTENSION



SAFE & SECURE
LOCK SYSTEM



ACCESS UNDER
DRAWER WINGS



100% Drawer extension
for complete access
with unique patented
slide system and
sealed bearings



MSA 4X4 ACCESSORIES is a trusted name in Australian 4WD storage solutions and has revolutionised the industry with its patented Explorer Aluminium Storage Drawer System!



CRASH TESTED &
ADR COMPLIANT

  [MSA4X4.COM.AU](https://www.msa4x4.com.au) | GEAR FOR LIFE

MSA
4X4 ACCESSORIES

AUSTRALIA'S BEST 4WD DRAWER SYSTEM

MSA 4X4 EXPLORER ALUMINIUM STORAGE DRAWER SYSTEM



Years of design, development and manufacturing knowledge goes into every MSA 4X4 product to ensure that our products are the very best they can be!

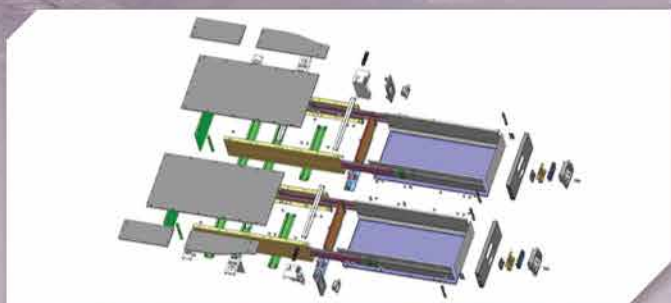

REDEFINING 4WD STORAGE DRAWER SYSTEMS

Designed from the ground up to establish the way a quality 4WD storage system should be.



CRASH TESTED & ADR COMPLIANT

The Explorer Aluminium Storage Drawer System has passed all the requirements prescribed by the ADRs and AS/NZS, without any structural weaknesses or degradation of the system to the extent that it would affect the safety of the vehicle occupants or other road users.



LIFETIME GUARANTEE

The MSA 4X4 Aluminium Storage Drawer System comes with a lifetime guarantee for customer peace of mind.



100% DRAWER EXTENSION

The unique patented "pro-glide" slide runner system and sealed bearings allow for 100% drawer extension & access. The entire drawer comes out further than the frame! No hard to reach items in our drawers and no unpacking of contents to reach items at the back!

FEATURES INCLUDE



100% ALUMINIUM CONSTRUCTION

with anodised aluminium components. Super strong, lightweight and lifetime corrosion resistance.



HEAVY DUTY CRASH TESTED 250KG

load rating per pair of drawers!



UP TO 25%

more internal drawer space with equivalent external frame dimensions.



PATENTED "STAY-OPEN BLOCK"

allows the drawer to remain in an open position, even on a 30 degree slope!



PATENTED INTERNAL LED STRIP LIGHT

delivering increased practicality, complete with manual override switch.



LIGHTER

than most generic steel drawers.

FEATURES INCLUDE



FLUSH FITTING REMOVABLE WING KITS will be available for most 4WDs and work utes, allowing access to storage areas beside the drawers.



ACCESS UNDER THE DRAWER WINGS now with removable wing face panels!



SUPPORTING WING KIT BRACKETS allow for Drop Slides and Fridge Slides to be installed onto the wings - maximising space in the vehicle.



WING KITS DESIGNED to clip in or bolt in to allow complete access to valuable storage space around the drawer modules.



PATENTED 'PRO-GLIDE' SYSTEM utilises the side of the drawers and the frame as the slide unit. The over extension using custom sealed bearings removes the need for additional slide components, maximising storage space.

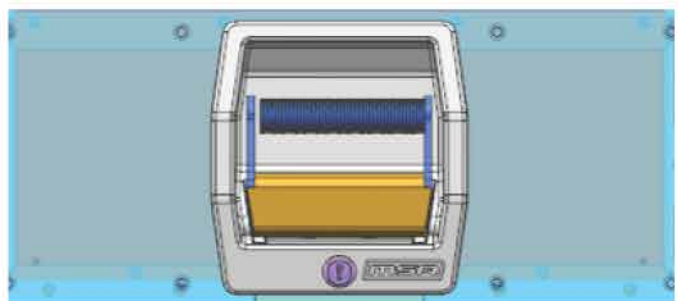

100% SAFE & SECURE lock system cannot be levered open from underneath.

FEATURES INCLUDE



DUST RESISTANT DESIGNED

seal around front panel resists ingress.



STAINLESS STEEL

fasteners used throughout where possible for a rust free and problem free life!



FLOOR EXTENSIONS

included as standard with relevant Wing Kits.



CRASH TESTED

cargo barrier mount points and child restraint points incorporated into the rear of the drawer frame as standard.



REINFORCED & INJECTION MOULDED

components and wing brackets ensuring a quality product that is super strong and will never rust!

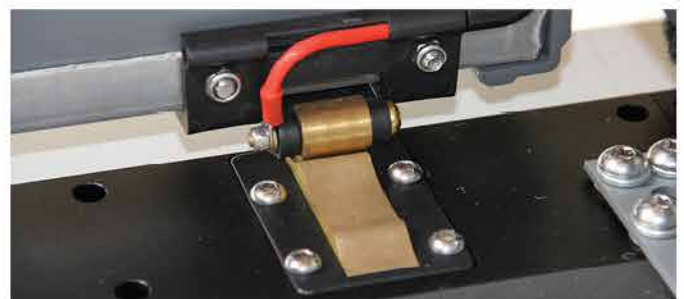

INTEGRATED ELECTRICAL CIRCUIT

contacts for switched LED light removes the need for any moving wires.

FEATURES INCLUDE



EASY TO KEEP CLEAN

12mm waterproof marine plywood, covered with a fine UV stabilised polyester marine carpet for a professional finish.



INJECTION MOULDED

design registered lock system with purpose built injection moulded frame & components. Anodised knurled aluminium handle for comfort & practicality.



FLUSH FINISH

internal drawer sides provide greater storage practicality without any internal folds.



AVAILABLE IN A VARIETY

of different lengths & sizes, to suit most wagons, utes and vans. We try to maximise drawer capacity in each vehicle where possible for maximum storage.



FULLY COMPATIBLE

with the full range of MSA 4X4 Drop Slides & Fridge Barriers. The Modular System means units can also be coupled together side by side or on top of one another.



OPTIONAL ACCESSORIES AVAILABLE

to suit your drawer system. Coming soon!

DRAWER DIMENSIONS

7



EXPLORER DRAWER SYSTEM

E930A

E930

E1030

E1350

SINGLE DRAWER

EXTERNAL DIMENSIONS (mm)

Overall complete drawer length including handle lock	945	945	1045	1365
Overall complete drawer height	275	275	275	275
Overall single drawer width - No wings	510	530	530	530
Overall double drawer width - No wings	1020	1060	1060	1060

INTERNAL DIMENSIONS (mm)

Usable drawer height to under top deck	215	215	215	215
Drawer height	211	211	211	211
Internal drawer length	830	830	930	1250
Internal drawer width	433	453	453	453

REAR FRAME BOLTS ARE 10mm

MSA
4X4 ACCESSORIES

POWER PANEL

New Anodised Aluminium Power Panel designed to suit the MSA 4X4 Explorer Aluminium Storage Drawer System!



WATER PUMP SWITCH



COMPRESSOR SWITCH



AUX LIGHT SWITCH



2X USB PORTS



2X 12V PORTS



PART NO: EPP-LEFT



PART NO: EPP-RIGHT

This pre-wired, 3 Way Power Panel is designed for convenient fitment, and includes:

- ✓ 3 x labelled, illuminated Rocker switches (Aux Light, Compressor & Water Pump) and 2 spare switch covers (1 x Fridge & 1 x Inverter)
- ✓ 2 Port 4.2A (combined) USB charging outlets
- ✓ 2 x cigarette lighter sockets
- ✓ Illuminated voltage gauge display
- ✓ Angled sockets to suit being installed on the front of a set of drawers, so that accessory plugs in use, don't hit the vehicle tailgate
- ✓ Pre-wired for faster installation
- ✓ Unique injection-moulded backing cover also included which protects the back of the switches and wiring from loose items stored under the drawer wing

Specifications:

Front Panel Dimensions: 11.2cm (W) x 19.4cm (H) x 4cm (D)

Rear Backing Dimensions: 10.8cm (W) x 15cm (H) x 4cm (D)

