



RHINO-RACK

Nissan Pathfinder Rail Removal Instructions (ACC01 - Plug Kit)

Important: Please read these instructions carefully prior to installation. Please refer to your fitting instruction to ensure that the rack is installed in the correct locations. Check the contents of kit before commencing fitment and report any discrepancies. Place these instructions in the vehicle's glove box after installation is complete.

Layout

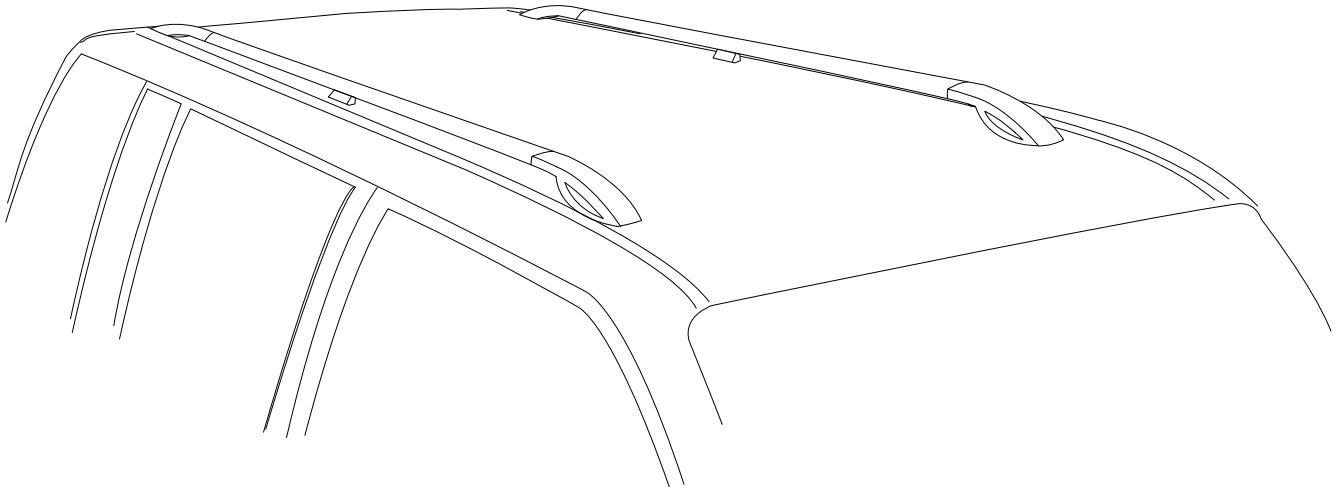

Important Information

Maximum carrying capacity: Refer to Pathfinder Track Mount instruction RTS506

Load must be evenly distributed over the crossbars. Please refer to your vehicle manufacturers handbook for maximum carrying capacity. Always use the lower of the two figures. Load must be evenly distributed over the crossbars.

Recommendations:

All bolt connections must be checked after driving a short distance when you first install your roof racks. Bolt connections should be checked again at regular intervals (every 1000km or depending on road conditions, usage, loads and distances travelled). You should also check the condition of your roof racks each time they are re-fitted. Always make sure to fasten your load securely. Please also ensure that all loads are evenly distributed and that the centre of gravity is kept as low as possible. Remove any wind resisting loads before travelling.

Roof racks must be removed when putting vehicle through an automatic car wash.

Caution: The handling characteristics of the vehicle changes when you transport a load on the roof. For safety reasons we recommend you exercise extreme care when transporting wind-resistant loads. Special consideration must be taken into account when cornering and braking.

Note for Dealers and Fitters

It is your responsibility to ensure this fitting instruction is given to the end user or client. Place these instructions in the vehicle's glove box after installation is complete.

Rhino-Rack
3 Pike Street, Rydalmere,
NSW 2116, Australia.
(Ph) (02) 9638 4744
(Fax) (02) 9638 4822

Document No: R201
Prepared By: Adrian Rankilor
Authorised By: Chris Murty

Issue No: 01
Issue Date: 4/6/2012

These instructions remain the property of Rhino-Rack Australia Pty Ltd and may not be used or changed for any other purpose than intended.



Nissan Pathfinder Rail Removal Instructions (ACC01 - Plug Kit)

Parts List

Item	Component Name	QTY	Part No.
1	Black Plugs M6	17	CA1141
2	Fitting Instruction	1	R201

Tools Needed

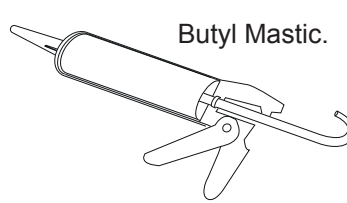

Butyl Mastic.

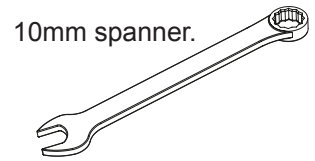

10mm spanner.

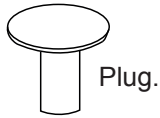

Plug.

Instructions

1

Remove Front cover, to gain access to the M6 screws.

2

Remove M6 screws using a 10mm socket.

3

Remove Rear cover, to gain access to the M6 screws.

Remove M6 screws using a 10mm socket as per step 2.



Nissan Pathfinder Rail Removal Instructions (ACC01 - Plug Kit)

4

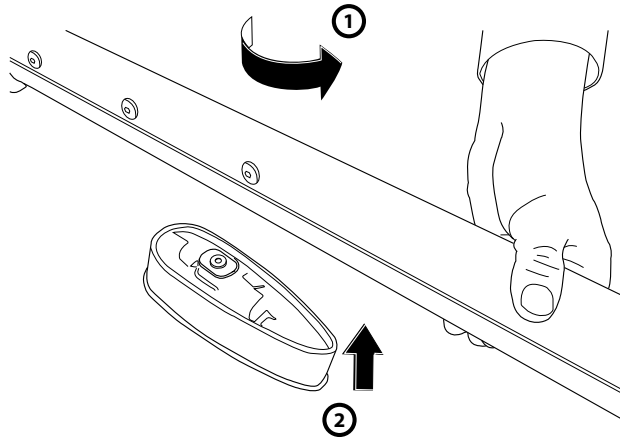

Slide Rail forward to disengage centre mount.

Remove M6 screws in centre mount as per step 2.

Clean roof with car polish around these areas

5

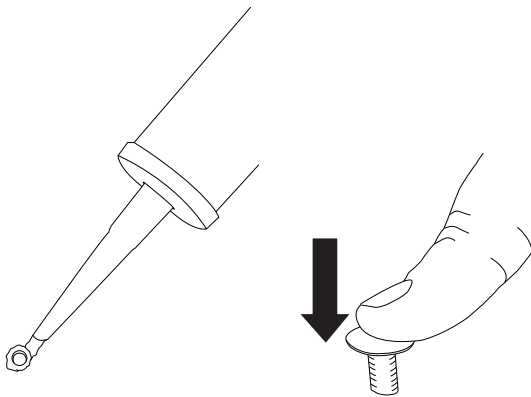

Use a small amount of Butyl Mastic around the exposed M6 threaded holes for water sealant.

Push in Black Plug to cover and seal the holes.

6

Rail removal is complete

