



FITTING INSTRUCTIONS

Product:	T15 Fleet Frontal Protection System
Vehicle:	Toyota Hilux 07-2011+
Part No.	070SB15F87B 070SB15N87B 070SB13N87B 070SB15FT87B 070SB15NT87B

Australian Standards Relating to Installing Vehicle Frontal Protection Systems (VFPS): AS 4876.1-2002

- Do not attach V.F.P.S. to vehicle using anchorages not intended for this purpose (e.g. engine mounting bolts), other than those specified by the V.F.P.S. manufacturer in this instruction.
- Do not use this product for any vehicle make or model other than those specified by the V.F.P.S. manufacturer (as above).
- Do not remove any plaques or labels from the V.F.P.S.
- Do not modify the structure of the V.F.P.S. in any way.

Warranty

- If any product or part of a product manufactured by TJM is found to be defective during a period of three (3) years after the date of purchase, TJM shall repair (at TJM's discretion) the defective product or part.
- Any defect in a product distributed by TJM, but not manufactured by TJM, shall be dealt with in accordance with, and to the extent of, the warranty offered by the manufacturer of that product.
- TJM does not warranty that the products manufactured by it comply with the laws of the place where those product are purchased or used. It is the sole responsibility of the purchaser to ascertain whether products being purchased, or the affixation of those products to any other object, comply with local laws.
- Except to the extent described in this warranty, TJM shall not be liable for any other claims, including claims arising from incorrect fitment, product or vehicle modification, faulty design, the use of the product on any indirect special or consequential damage or injury to any person, company or other entity.
- Modification or alteration to any product manufactured by TJM to enable fitment in conjunction with other vehicle accessories or modifications (e.g. lift kits) will void any warranty claims.

- **Read instructions fully before commencing fitment.**
- **Estimated Fitting Time: 1.5hrs**
- **Left hand and Right hand components are determined as seated in the vehicle.**
- **Check for (and remove) any build up in all captive nuts fitted to the FPS.**

Bolt tensions	Dia. (mm)	Nm	ft.lbs	Dia. (inch)	Nm	ft.lbs
All bolt tensions are as follows unless otherwise specified.	5	5	4	1/4"	9	7
	6	9	7	5/16"	22	15
	8	22	16	3/8"	33	27
	10	44	32	7/16"	55	43
	12	77	57	1/2"	86	66

For further information contact T.J.M. Head Office on (07) 3865 9999. Distributors Australia wide.



FITTING INSTRUCTIONS

Product:	T15 Fleet Frontal Protection System
Vehicle:	Toyota Hilux 07-2011+
Part No.	070SB15F87B 070SB15N87B 070SB13N87B 070SB15FT87B 070SB15NT87B

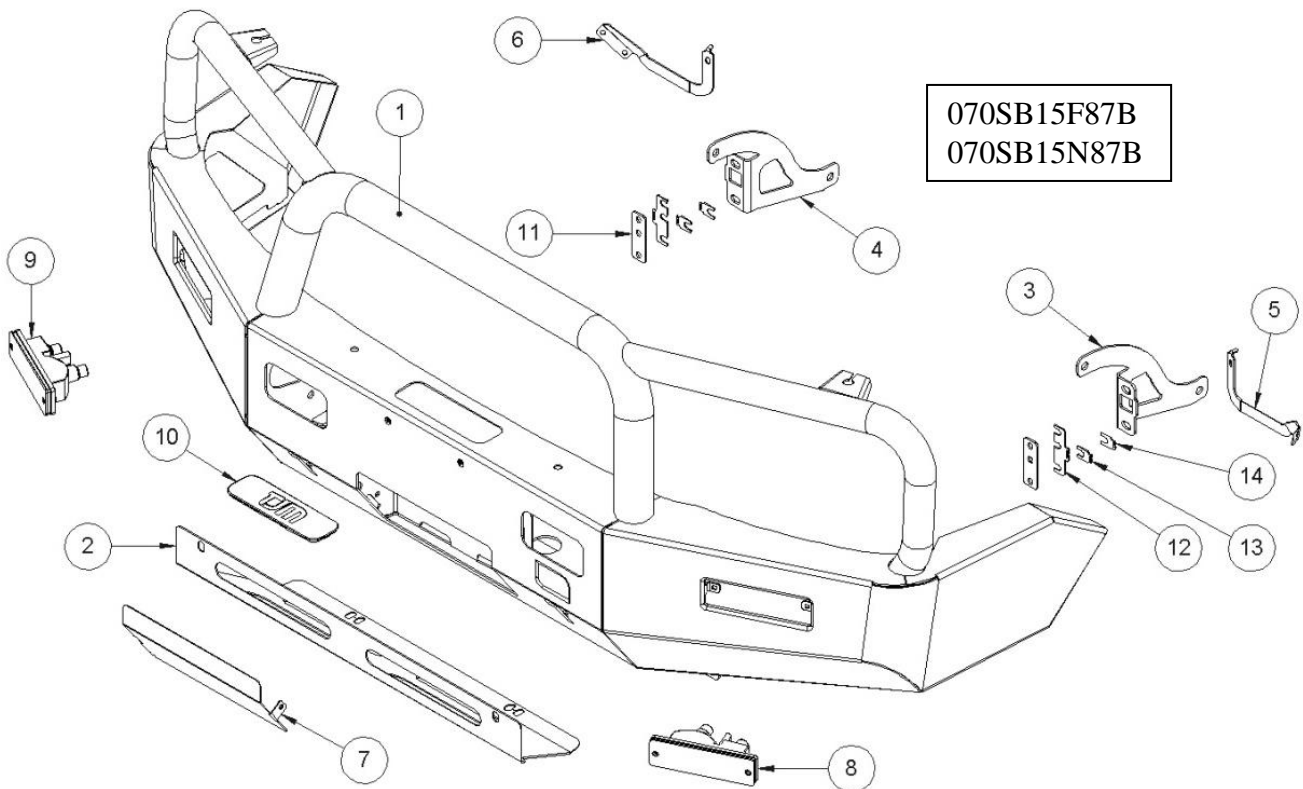

ITEM NO.	Description	Qty	Part Number
PARTS LIST			
1	Fleet FPS	1	F-750 / F-760 F1131 / F1132
2	Guard	1	87972
FITTING KIT			
3	Chassis Brace LH	1	87669L
4	Chassis Brace RH	1	87669R
5	Inner Guard Support LH	1	MTST-T378
6	Inner Guard Support RH	1	MTST-T377
7	Fairlead Cover	1	87975
8	Indicator / Park Light LH	1	90372
9	Indicator / Park Light RH	1	90373
10	Fairlead Cover Plate	1	92106
N/A	Pinch-weld (500mm Long)	2	K3219

ITEM NO.	Description	Qty	Part Number
BOLT KIT			
N/A	M6 x 1.0 x 16mm Hex Head Screw	8	K1232
N/A	M6 x 1.0 x 12mm Pan Head Screw	2	K3273
N/A	M6 x 1.0 Flange Nut	8	K3033
N/A	1/4" x Ø3/4" Flat Washer	12	K2905
N/A	M10 x 1.25 x 35mm Hex Head Bolt	6	K0565
N/A	M10 x 1.25 Hex Nut	6	K0579
N/A	M10 Spring Washer	6	K0621
N/A	M10 x Ø21mm Flat Washer	10	K2900
11	M10 Washer Plate	2	87976
N/A	M12 x 1.25 x 35mm Hex Head Screw	2	K0570
N/A	M12 Spring Washer	2	K0977
N/A	M12 x Ø24mm Flat Washer	2	K0425
N/A	Scotch-Lock	6	K0419
N/A	Nylon Plug	4	K0665
12	Shim A	2	88358
13	Shim B	2	88359
14	Shim C	2	88360
N/A	Bumper Trim Template	1	F-874-T



FITTING INSTRUCTIONS

Product: T15 Fleet Frontal Protection System

Vehicle: Toyota Hilux 07-2011+

Part No. 070SB15F87B 070SB15N87B 070SB13N87B 070SB15FT87B 070SB15NT87B

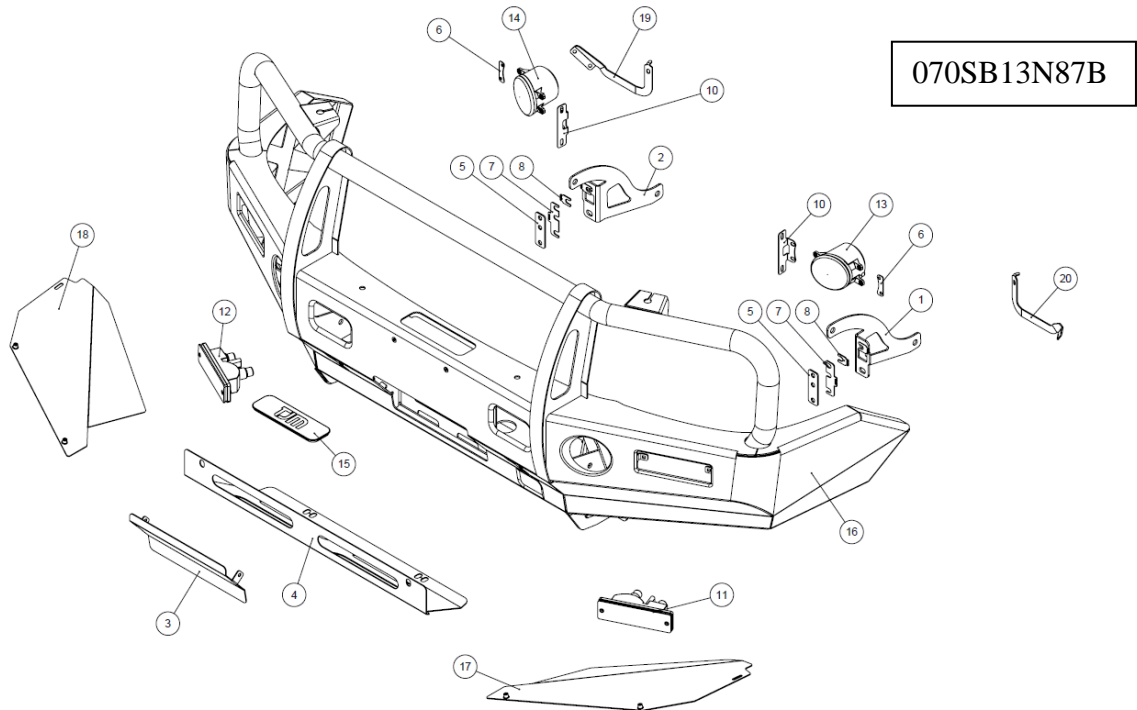

ITEM NO.	Description	Qty	Part Number
PARTS LIST (070SB13N87B)			
16	T13 Bar Assembly	1	F-889
4	Guard	1	87972

ITEM NO.	Description	Qty	Part Number
FITTING KIT (070SB13N87B)			
1	Chassis Brace LH	1	87669L
2	Chassis Brace RH	1	87669R
3	Fairlead cover plate	1	87704
11	Indicator / Park Light LH	1	90372
12	Indicator / Park Light RH	1	90373
13	General Fog Light LH - ESUSE	1	92102L
14	General Fog Light RH - ESUSE	1	92102R
15	Winch Slot Cover Plate	1	92106
17	Wing under guard LH	1	F-902L
18	Wing under guard RH	1	F-902R
19	Inner Guard Bracket RH	1	MTST-T377
20	Inner Guard Bracket LH	1	MTST-T378
N/A	Pinch-weld (500mm Long)	2	K3219
N/A	Fog Light Switch	1	92272

ITEM NO.	Description	Qty	Part Number
BOLT KIT (070SB13N87B)			
N/A	M6 x 1.0 x 16mm Hex Head Screw	20	K1232
N/A	M6 x 1.0 x 20mm Hex Head Screw	6	K0550
N/A	M6 x 1.0 x 12mm Pan Head Screw	2	K3273
N/A	M6 x 1.0 Flange Nut	20	K3033
N/A	M6 x 1.0 Nyloc Nut	2	K0605
N/A	M6 Spring Washer	4	K0915
N/A	M6 x Ø12.5mm Flat Washer	12	K0897
N/A	1/4" x Ø3/4" Flat Washer	20	K2905
N/A	M10 x 1.25 x 35mm Hex Head Bolt	6	K0565
N/A	M10 x 1.25 Hex Nut	6	K0579
N/A	M10 Spring Washer	6	K0621
N/A	M10 x Ø21mm Flat Washer	10	K2900
5	M10 Washer Plate	2	87976
N/A	M12 x 1.25 x 35mm Hex Head Screw	2	K0570
N/A	M12 Spring Washer	2	K0977
N/A	M12 x Ø24mm Flat Washer	2	K0425
N/A	Scotch-Lock	6	K0419
N/A	Nylon Plug	4	K0665
6	Foglight Washer Plate	2	88057
7	Shim A	2	88358
8	Shim B	2	88359
9	Shim C	2	88360
10	Fog-Light Angle Bracket	2	89745

For further information contact T.J.M. Head Office on (07) 3865 9999. Distributors Australia wide.



FITTING INSTRUCTIONS

Product: T15 Fleet Frontal Protection System

Vehicle: Toyota Hilux 07-2011+

Part No. 070SB15F87B 070SB15N87B 070SB13N87B 070SB15FT87B 070SB15NT87B

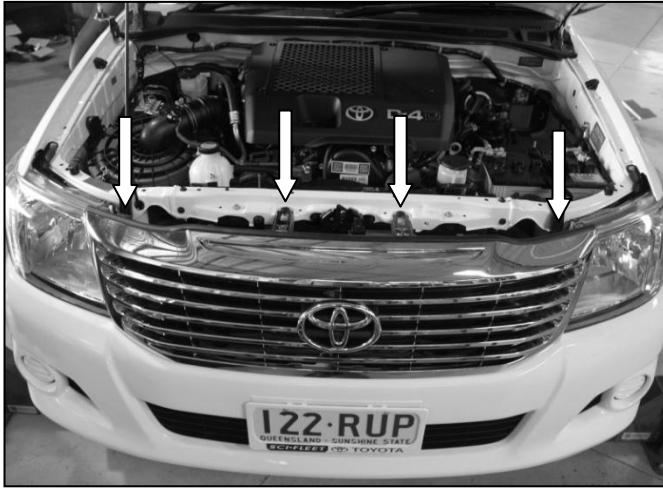

1. Remove (& retain) the plastic clips (2) & screws (2) that are retaining the top of the grille.

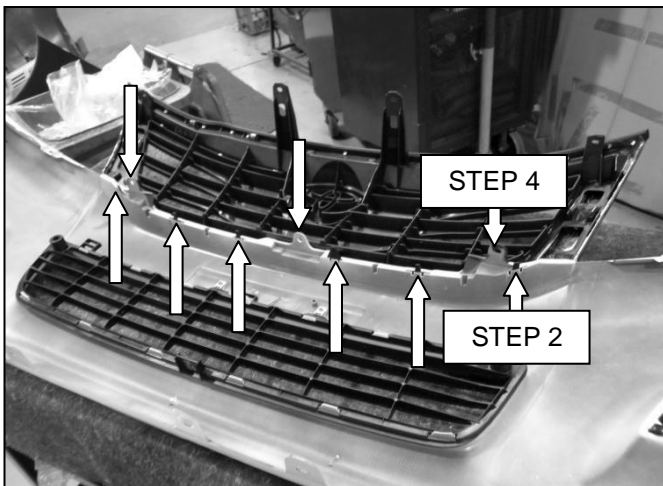
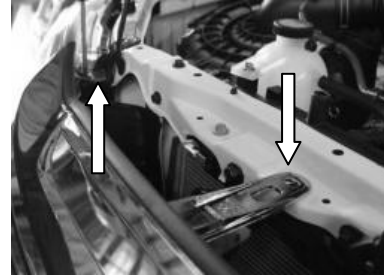

2. Carefully disengage the clips (6) at the bottom of the grille, located on the inside.
3. Remove the grille & set it aside, storing it carefully.
4. From along the top of the bumper, where the bottom of the grille was, remove (& retain) the newly exposed clips (3).

The bumper & grille are shown removed so as to clearly indicate the location of the clips.

RHS SHOWN

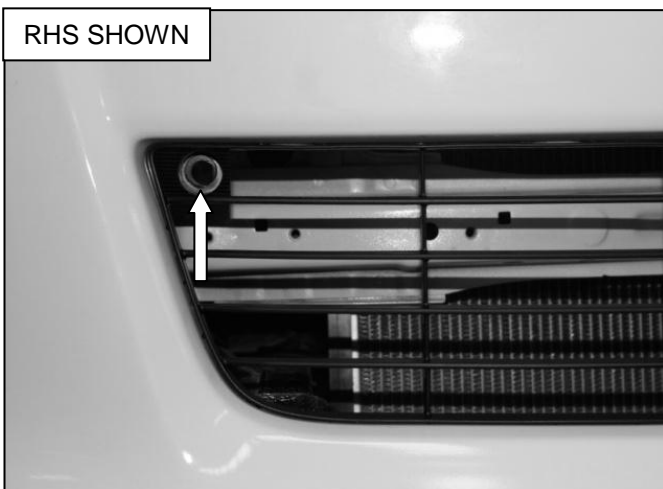

5. Remove (& discard) the screws (2) that are securing the lower air intake in place.

For further information contact T.J.M. Head Office on (07) 3865 9999. Distributors Australia wide.



FITTING INSTRUCTIONS

Product:	T15 Fleet Frontal Protection System
Vehicle:	Toyota Hilux 07-2011+
Part No.	070SB15F87B 070SB15N87B 070SB13N87B 070SB15FT87B 070SB15NT87B

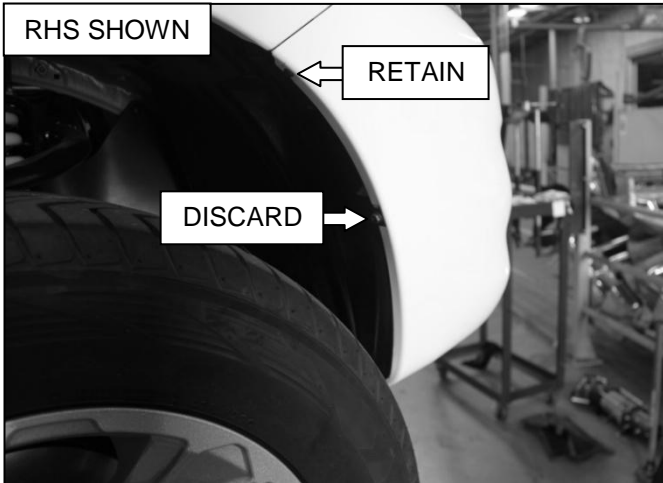

6. Release the plastic inner guard from the bumper, retaining the upper fastener, whilst discarding the lower one.
7. Repeat the previous step for the opposite side of the vehicle.

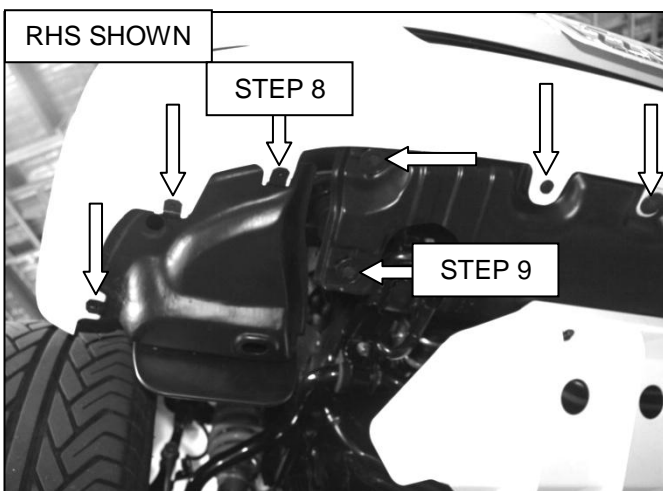

8. Remove (& discard) the plastic clips from the bottom of the bumper.
9. Remove (& discard) the plastic clips from the plastic stone guard.
10. If O.E. fog-lights are installed, disconnect the wiring loom from the fog-lights.
11. Remove the bumper from the vehicle, setting it aside, carefully.

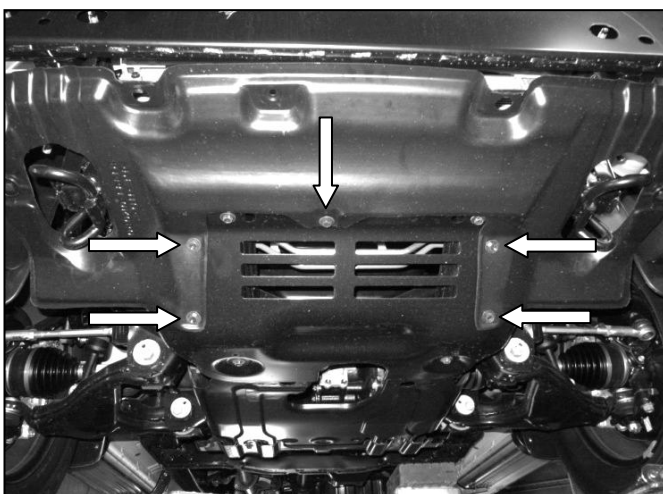

12. Remove (& discard) the plastic stone guard (& associated fasteners) from the vehicle.



FITTING INSTRUCTIONS

Product: T15 Fleet Frontal Protection System

Vehicle: Toyota Hilux 07-2011+

Part No. 070SB15F87B 070SB15N87B 070SB13N87B 070SB15FT87B 070SB15NT87B

RHS SHOWN

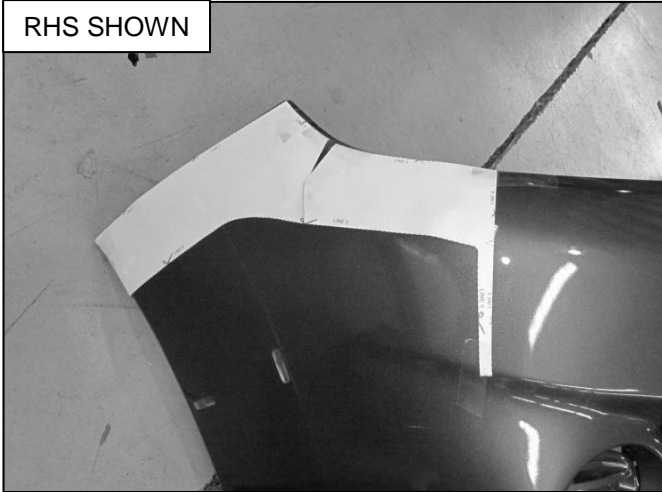

Steps 13 through to 23 only apply if fitting an 070SB15N87B & 070SB15NT87B. Otherwise, please proceed to step 24.

13. Following the process on the bumper trim template, attach the template to the bumper.
14. Using the bumper trim template as a guide, mark the trim line on the bumper.
15. Repeat the two previous steps for the opposite side of the bumper.

RHS SHOWN

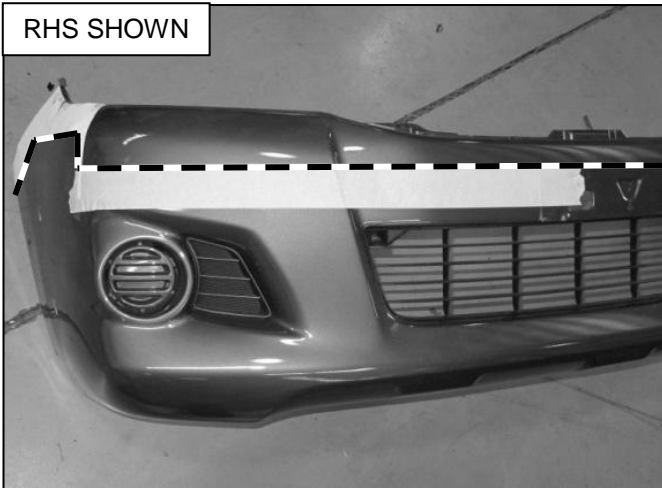

16. Mask a horizontal line from the top mold line of the number-plate mount face, across the bumper until it intersects with both bumper trim templates (as shown).
17. Using the masking tape as a guide, mark the trim line on the bumper, above the masking tape.
18. Following the trim line, remove (& discard) the lower section of the bumper.
19. De-burr the edges & clean the area/surface of any swarf/debris.

RHS SHOWN

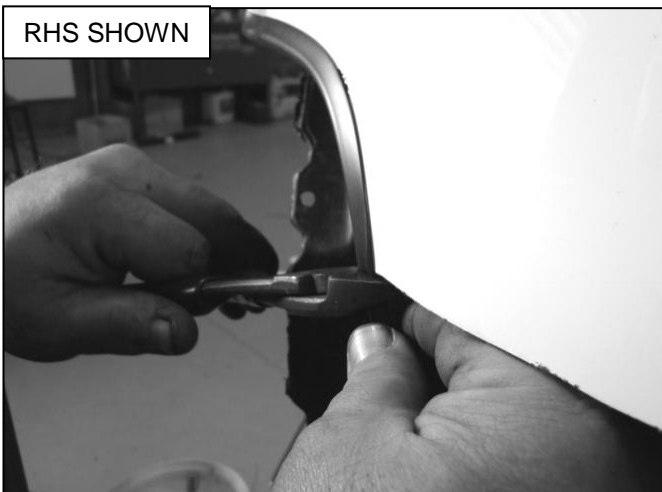

20. Fit the pinch-weld to the trimmed end of the bumper.
21. Trim off any excess from the ends of the pinch-weld.
22. Use super-glue at the ends of the pinch-weld to ensure that it does not come loose.
23. Repeat the three previous steps for the opposite side of the bumper.

For further information contact T.J.M. Head Office on (07) 3865 9999. Distributors Australia wide.



FITTING INSTRUCTIONS

Product: T15 Fleet Frontal Protection System

Vehicle: Toyota Hilux 07-2011+

Part No. 070SB15F87B 070SB15N87B 070SB13N87B 070SB15FT87B 070SB15NT87B

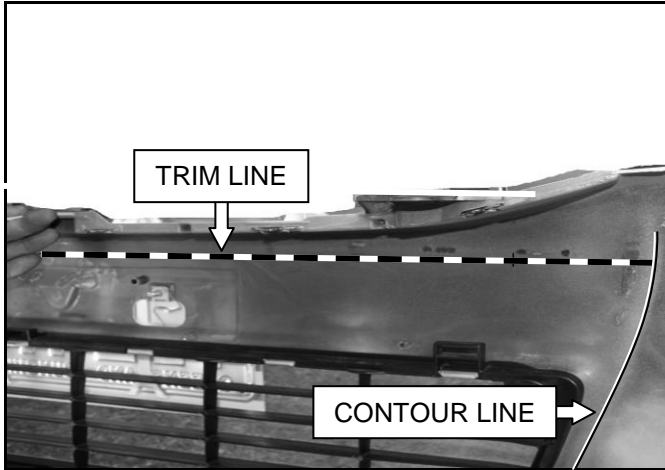

Steps 24 through to 30 only apply if fitting an 070SB15F87B, 070SB15FT87B & 070SB13N87B. Otherwise, please proceed to step 31.

24. Remove (& retain) the flarettes from the bumper ends.
25. On the center of the bumper, mark the trim line along the bumper mold line (as shown), to the indicated bumper contour line, on both sides of the vehicle.

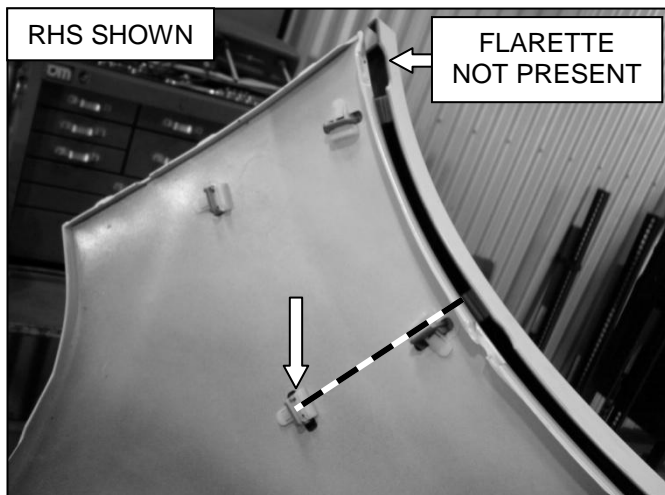

26. On the outer end of the bumper, mark a trim line from the indicated flarette clip opening, out to the edge of the bumper, aligning the trim line with top of the rear flarette clip opening.

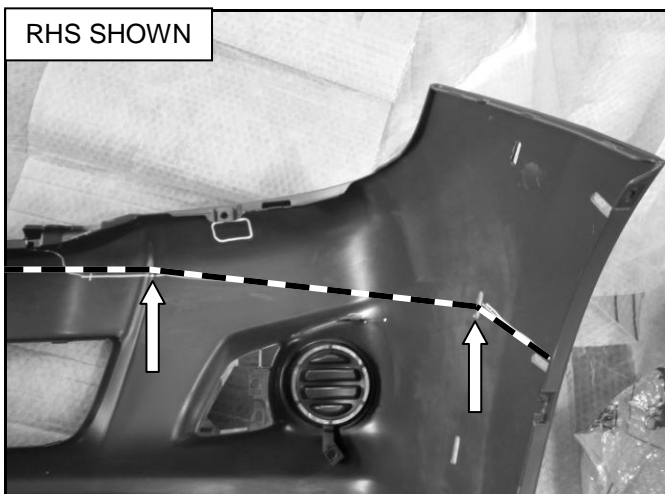

27. Mark a trim line, joining the lines previously created.
28. Repeat the two previous steps for the opposite side of the bumper.
29. Following the trim lines, remove (& discard) the lower section of the bumper.
30. De-burr the edges & clean the area/surface of any swarf/debris.

For further information contact T.J.M. Head Office on (07) 3865 9999. Distributors Australia wide.



FITTING INSTRUCTIONS

Product: T15 Fleet Frontal Protection System

Vehicle: Toyota Hilux 07-2011+

Part No. 070SB15F87B 070SB15N87B 070SB13N87B 070SB15FT87B 070SB15NT87B

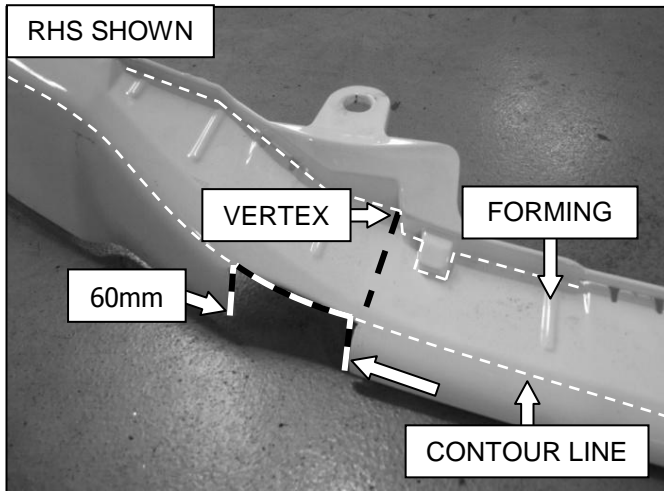

31. From the indicated vertex, mark a line straight down the bumper, parallel to the indicated formings.
32. Parallel to this, mark a trim line, 60mm towards the outside of the vehicle.
33. Following the indicated contour line, mark a trim line, joining the lines previously created.
34. Following the trim lines, remove (& discard) the rectangular section of the bumper.
35. Repeat the previous four steps for the opposite side of the bumper.
36. De-burr the edges & clean the area/surface of any swarf/debris.
37. Set the bumper aside, storing it carefully.
38. Remove (& discard) the bumper support brackets (& associated fasteners).

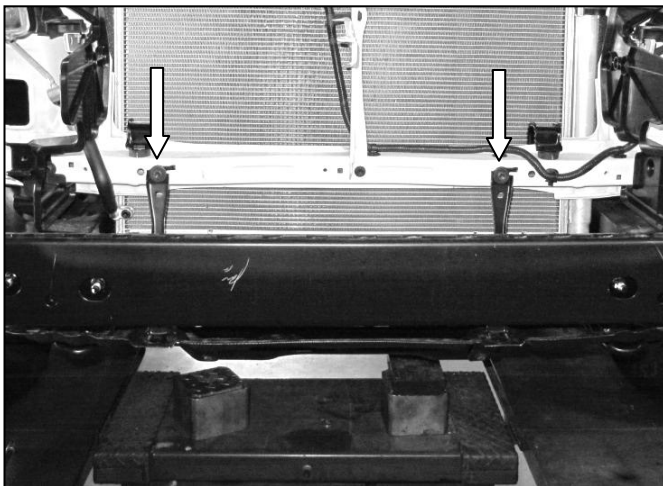

39. Remove (& discard) the front intrusion beam, retaining the fasteners (4).

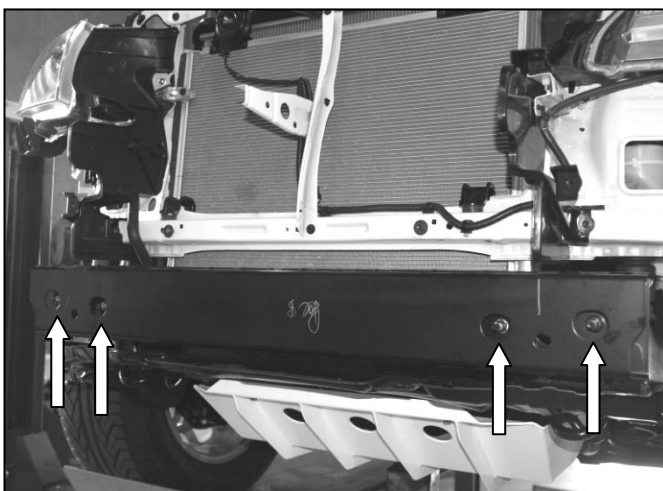

For further information contact T.J.M. Head Office on (07) 3865 9999. Distributors Australia wide.



FITTING INSTRUCTIONS

Product: T15 Fleet Frontal Protection System

Vehicle: Toyota Hilux 07-2011+

Part No. 070SB15F87B 070SB15N87B 070SB13N87B 070SB15FT87B 070SB15NT87B

RHS SHOWN

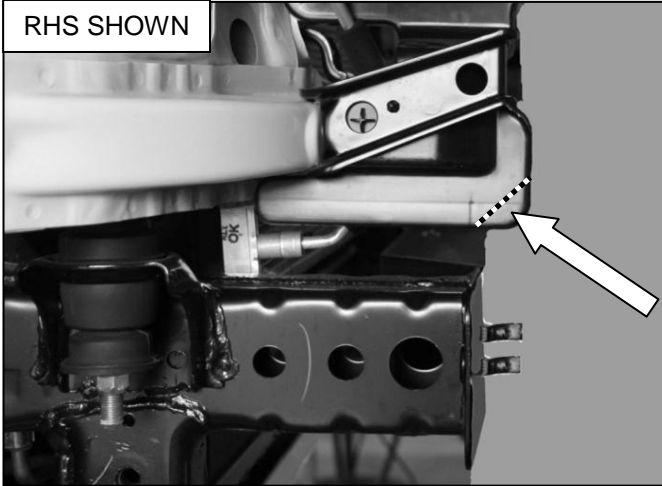

40. Trim the front corner of the lower air guide as indicated (diagonally back to the front face of chassis ends, at approximately 45°).
41. Repeat the previous step for the opposite side of the vehicle.



42. Re-fit the bumper to its original position, using the fasteners retained in step 4.
43. Re-fit the grille assembly to its original position, using the fasteners retained in step 1.

Ensure that the grille is clipped in place thoroughly, as per its original fitment (step 2).

RHS SHOWN

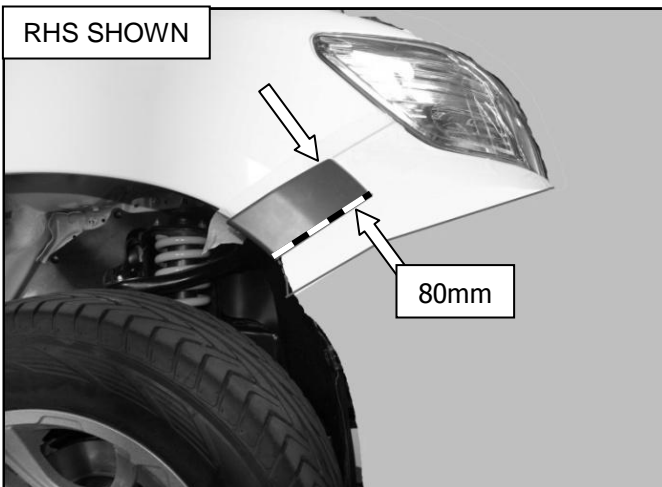

44. Cut the flare 80mm from the end (& discard the longer section).
45. Fit the pinch-weld to the trimmed end of the flare.
46. Trim off any excess from the ends of the pinch-weld.
47. Use super-glue at the ends of the pinch-weld to ensure that it does not come loose.
48. Re-fit the trimmed flare piece to the bumper.
49. Repeat the five previous steps for the opposite side of the vehicle.

For further information contact T.J.M. Head Office on (07) 3865 9999. Distributors Australia wide.



FITTING INSTRUCTIONS

Product:	T15 Fleet Frontal Protection System
Vehicle:	Toyota Hilux 07-2011+
Part No.	070SB15F87B 070SB15N87B 070SB13N87B 070SB15FT87B 070SB15NT87B

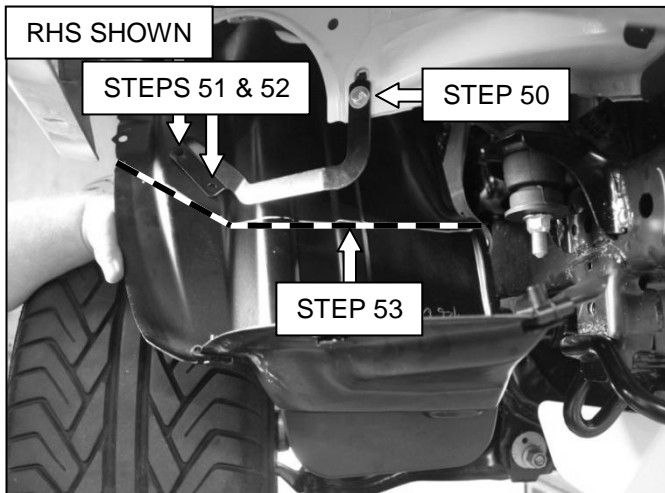

50. Positioning the inner guard support as shown, secure it in place, using an M6 x 1.0 x 16mm hex screw (1), 1/4" x Ø3/4" flat washer (1) & M6 flange nut (1).
51. Using the two holes in the inner guard support as a guide, drill two Ø6mm holes through the plastic inner guard.
52. Secure the inner guard support to the plastic inner guard, using M6 x 1.0 x 16mm hex screws (2), 1/4" x Ø3/4" flat washers (4) & M6 flange nuts (2).
53. Mark the plastic inner guard as shown & trim it to suit.

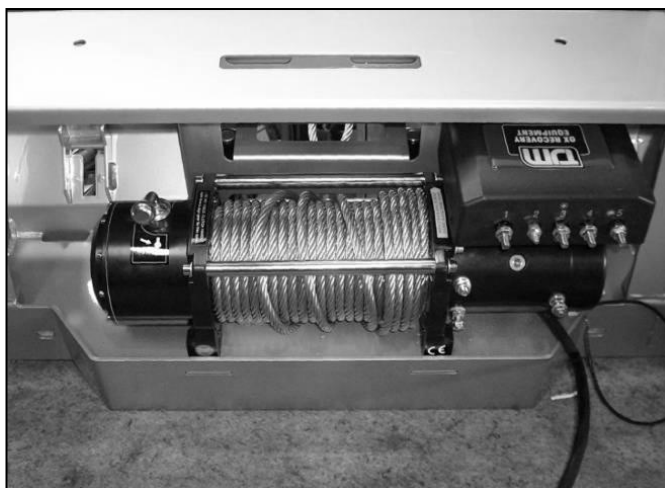

54. Repeat the four previous steps for the opposite side of the vehicle.
- Steps 55 & 56 only apply if a winch is to be fitted. Otherwise, please proceed to step 57.***
55. Locating the winch as shown, refer to the winch fitting instructions & fit the winch to the FPS.
 56. Using the fasteners supplied with the winch, fit the roller fairlead to the FPS.

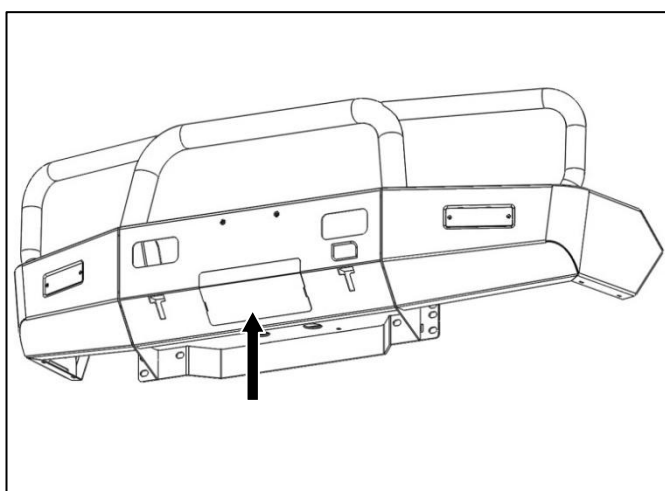

- Step 57 only applies if no winch has been fitted. Otherwise, please proceed to step 58.***
57. Position the fairlead cover plate as shown, then secure it in place, using M6 x 1.0 x 16mm hex screws (2), 1/4" x Ø3/4" flat washers (2) & M6 flange nuts (2).



FITTING INSTRUCTIONS

Product:	T15 Fleet Frontal Protection System
Vehicle:	Toyota Hilux 07-2011+
Part No.	070SB15F87B 070SB15N87B 070SB13N87B 070SB15FT87B 070SB15NT87B

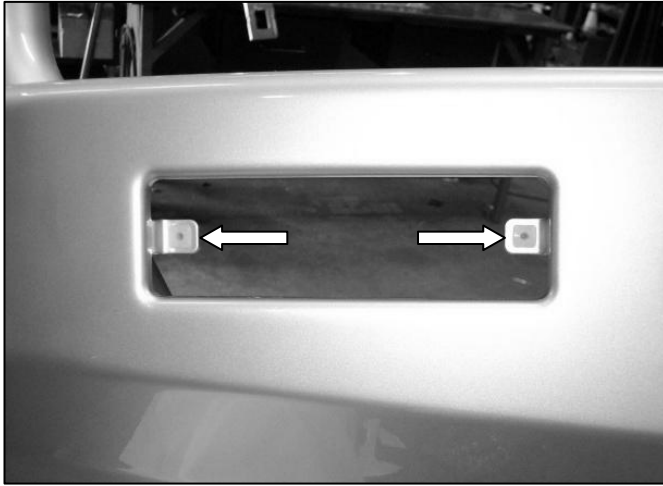

58. Using the scotch-locks supplied, install the indicator/park lights to the vehicle.
59. Check the operation of the indicator/park lights, then disconnect the light assemblies.
60. Insert the nylon plugs supplied, into the square cut-outs for the indicator/park lights (as shown).
61. Install the indicator/park light to the FPS using the screws provided with the light assembly.

Steps 62 through to 64 only apply if fitting an 070SB13N87B. Otherwise, please proceed to step 65

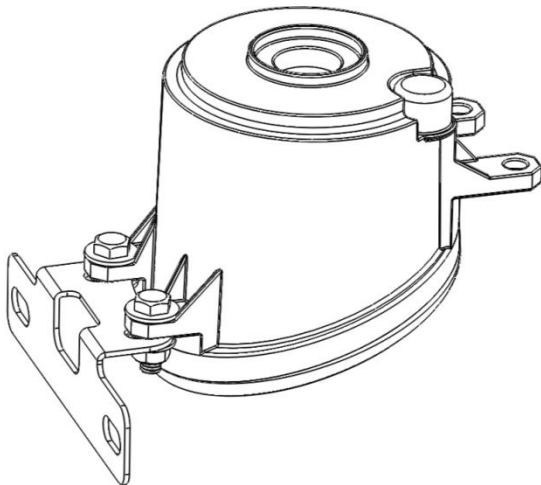

62. Loosely attach the fog-light angle bracket to the fog-light (as shown), using M6 x 1.0 x 16mm hex screws (2), M6 x Ø12.5mm flat washers (2) & M6 flange nuts (2).

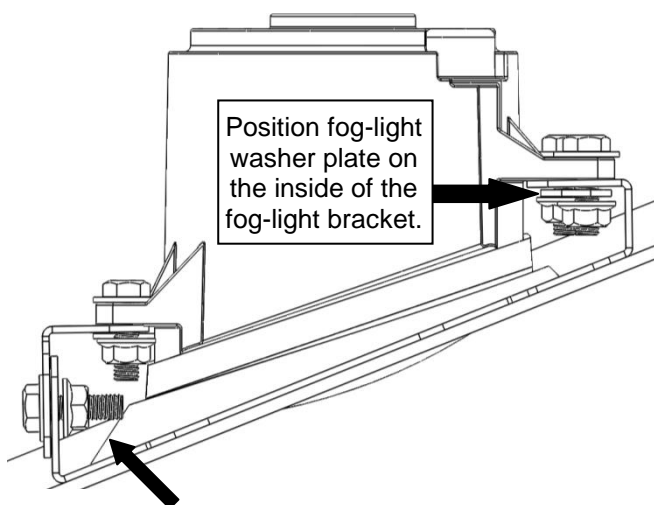

63. Attach the fog-light to the FPS (as shown), using M6 x 1.0 x 16mm hex screws (4), M6 x Ø12.5mm flat washers (4), M6 flange nuts (4) & a fog-light washer plate (1).

The fog-lights are left & right. Ensure that the wiring loom plug is facing the ground.

For further information contact T.J.M. Head Office on (07) 3865 9999. Distributors Australia wide.



FITTING INSTRUCTIONS

Product: T15 Fleet Frontal Protection System

Vehicle: Toyota Hilux 07-2011+

Part No. 070SB15F87B 070SB15N87B 070SB13N87B 070SB15FT87B 070SB15NT87B

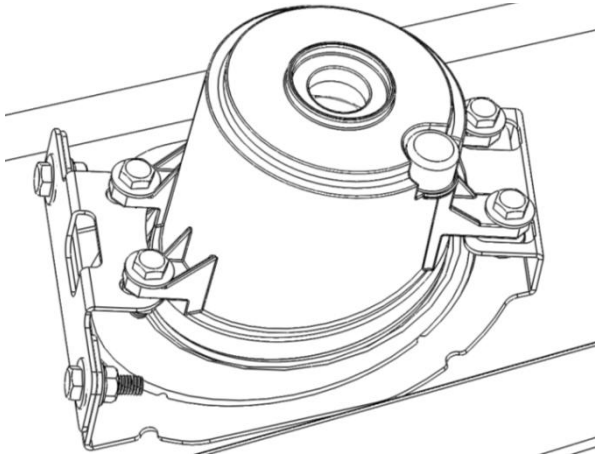

64. Repeat Steps 62 & 63 for the opposite side of the vehicle.

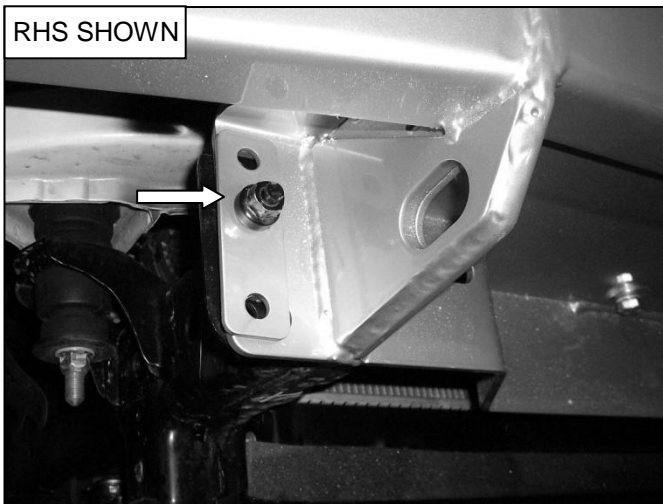

65. Lift the FPS into position onto the end of the chassis rail, positioning it over the captive stud as shown, then loosely secure the FPS in place, using the hex nuts retained in step 39 (2) & washer plates (2).

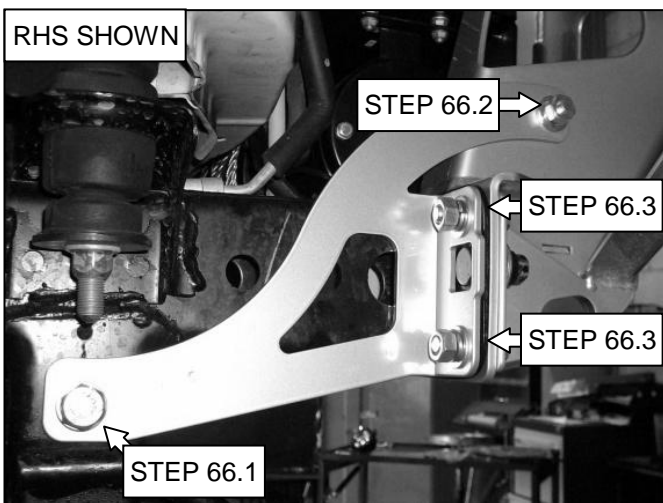

66. Position the chassis brace on the as shown, then loosely secure it in place, using the fasteners listed below:

66.1. M12 x 1.25 x 35mm hex bolt (1), M12 spring washer (1) & M12 x Ø24mm flat washer (1).

66.2. M10 x 1.25 x 35mm hex bolt (1), M10 spring washer (1), M10 x Ø21mm flat washers (2) & M10 hex nut (1).

66.3. M10 x 1.25 x 35mm hex bolts (2), M10 spring washers (2), M10 x Ø21mm flat washers (2) & M10 hex nuts (2).

67. Repeat the previous step for the opposite side of the vehicle.

For further information contact T.J.M. Head Office on (07) 3865 9999. Distributors Australia wide.



FITTING INSTRUCTIONS

Product:	T15 Fleet Frontal Protection System				
Vehicle:	Toyota Hilux 07-2011+				
Part No.	070SB15F87B	070SB15N87B	070SB13N87B	070SB15FT87B	070SB15NT87B



68. Align the FPS so that it is positioned evenly, ensuring that there is a minimum gap of 15mm, between the flare/bumper trim & the FPS.

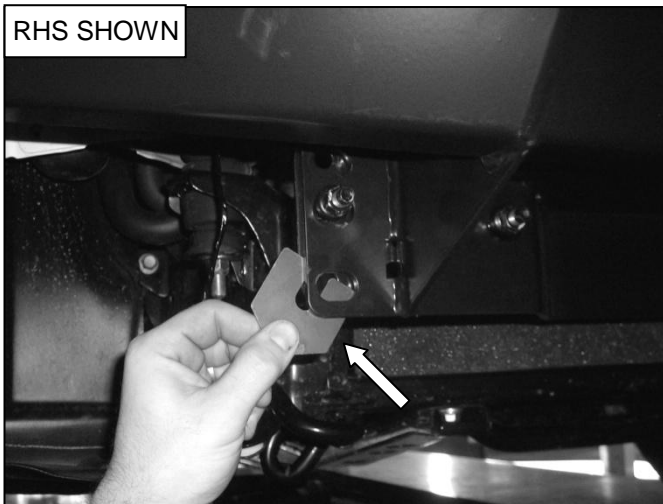

To achieve the desired position, it may be necessary to position a combination of the supplied shims, in between the end of the chassis rail & the FPS mount.

69. Tighten all of the previously installed fasteners, to the relevant torque settings listed on Page 1.
70. Re-connect the wiring for the indicator/park lights.

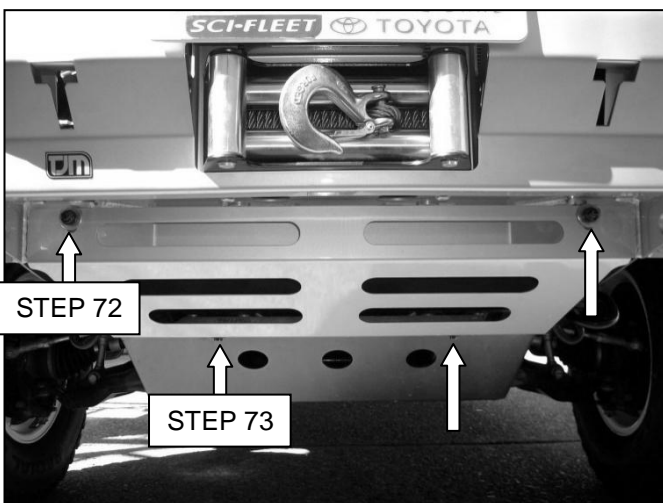

71. Remove (& retain) the front fasteners that are securing the OE stone tray in place.
72. Position the underbody guard as shown & secure it to the inner captive studs, in the end of the chassis rail, using the hex nuts retained in step 39 (2) & M10 x Ø21mm flat washers (2).
73. Secure the underbody guard in place, over the OE stone guard, using the fasteners removed in step 71, at their original location.



FITTING INSTRUCTIONS

Product: T15 Fleet Frontal Protection System

Vehicle: Toyota Hilux 07-2011+

Part No. 070SB15F87B 070SB15N87B 070SB13N87B 070SB15FT87B 070SB15NT87B

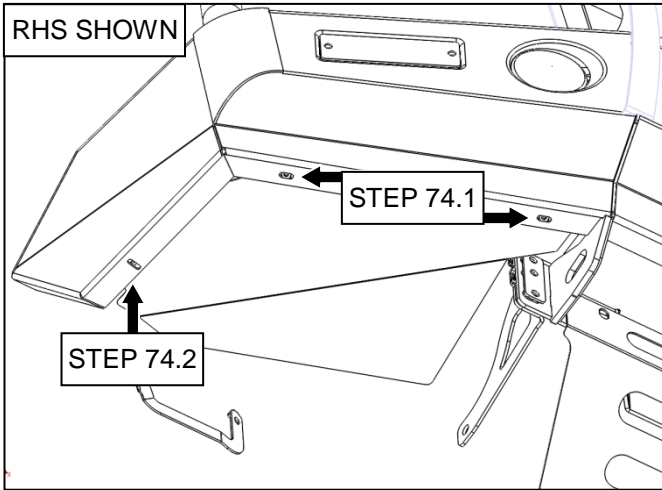

Step 74 only applies if an 070SB13N87B has been fitted. Otherwise, please proceed to step 77.

74. Position the wing guard inside the lower lip of the wing (as shown), then loosely secure it in place, using the fasteners listed below:
 - 74.1. M6 x 1.0 x 20mm hex bolts (2), M6 spring washers (2) & 1/4" x Ø3/4" flat washers (2).
 - 74.2. M6 x 1.0 x 20mm hex bolt (1), M6 nyloc nut (1) & 1/4" x Ø3/4" flat washers (2).
75. Tighten the previously installed fasteners.
76. Repeat the previous two steps for the opposite side of the vehicle.
77. Using M6 x 1.0 x 12mm pan screws (2), secure the number-plate in place, to the front of the FPS.
78. Place the winch slot cover in place in the winch viewing hole.
79. Ensure that all of the relevant wiring looms are connected & check that the indicators, park lights, winch, etc are functioning correctly.
80. Ensure that all of the fasteners are fully tightened to the appropriate torque settings & that, as a result of fitting the product, no vehicle components are crushed or will chafe.

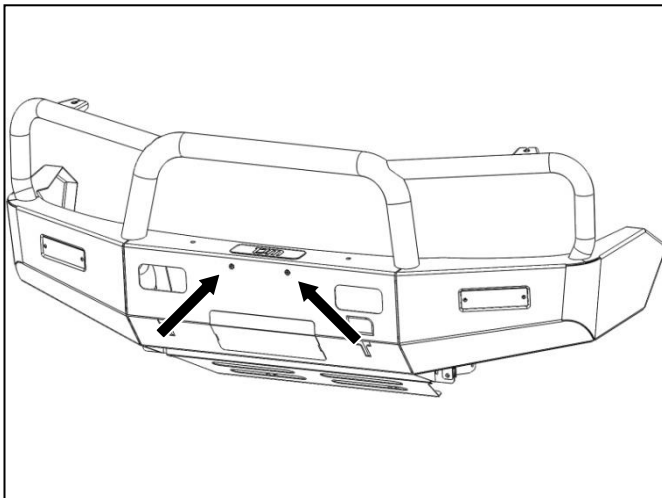

For further information contact T.J.M. Head Office on (07) 3865 9999. Distributors Australia wide.